

Standard Sprockets for 6mm Pitch British Standard Chain Type 04B

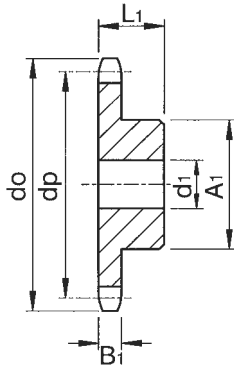

Simplex Sprockets

Chain No.	04B
Pitch	6.0mm
E Roller Diameter	4.0mm
F Inside Width	2.8mm
B ₁ Tooth Width	2.6mm

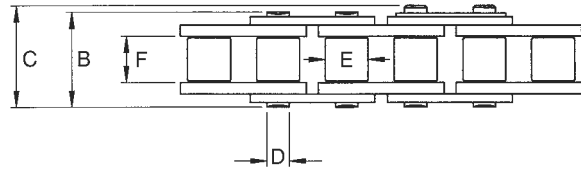

Chain Specifications

Chain No.	04B-1
Plate Depth	5.00
B Pin Length	7.40
C Overall Width	10.30
D Pin Diameter	1.85
Tensile Strength N	3000
Weight per Metre kg	0.12

No. Teeth Z	Pitch Circle Ø dp	Outside Ø do	Simplex Sprocket					
			Cat. No.	Min. † Bore d _i	Max. Bore	L.T.B. L ₁	Hub Ø A ₁	App. Weight kg
Steel Pinions								
8	15.68	18.0	04B1-08	5	6.5	10	9.8	0.006
9	17.54	19.9	04B1-09	5	7.5	10	11.5	0.008
10	19.41	21.7	04B1-10	6	8.5	10	13.0	0.010
11	21.29	23.6	04B1-11	6	9.5	10	14.0	0.012
12	23.18	25.4	04B1-12	6	11	10	16.0	0.016
13	25.07	27.3	04B1-13	8	12	10	18.0	0.019
14	26.96	29.2	04B1-14	8	13	10	20.0	0.024
15	28.86	31.1	04B1-15	8	13	10	20.0	0.025
16	30.76	33.0	04B1-16	8	13	13	20.0	0.033
17	32.65	35.0	04B1-17	8	13	13	20.0	0.035
18	34.55	36.9	04B1-18	8	13	13	20.0	0.037
19	36.46	38.8	04B1-19	8	13	13	20.0	0.039
20	38.36	40.7	04B1-20	8	13	13	20.0	0.041
21	40.26	42.6	04B1-21	8	15	13	25.0	0.058
22	42.16	44.5	04B1-22	8	15	13	25.0	0.060
23	44.06	46.4	04B1-23	8	15	13	25.0	0.062
24	45.97	48.3	04B1-24	8	15	13	25.0	0.065
25	47.87	50.2	04B1-25	8	15	13	25.0	0.068
26	49.78	52.1	04B1-26	8	20	15	30.0	0.098
27	51.68	54.0	04B1-27	8	20	15	30.0	0.101
28	53.59	55.9	04B1-28	8	20	15	30.0	0.104
29	55.49	57.8	04B1-29	8	20	15	30.0	0.108
30	57.40	59.8	04B1-30	8	20	15	30.0	0.111
31	59.31	61.7	04B1-31	8	20	15	30.0	0.114
32	61.21	63.6	04B1-32	8	20	15	30.0	0.118
33	63.12	65.5	04B1-33	8	20	15	30.0	0.122
34	65.03	67.4	04B1-34	8	20	15	30.0	0.125
35	66.94	69.3	04B1-35	8	20	15	30.0	0.129
36	68.84	71.2	04B1-36	8	20	15	30.0	0.133
37	70.75	73.1	04B1-37	8	20	15	30.0	0.137
38	72.66	75.0	04B1-38	8	20	15	30.0	0.141
39	74.57	76.9	04B1-39	8	20	15	30.0	0.146
40	76.48	78.9	04B1-40	8	20	15	30.0	0.150
45	86.01	88.5	04B1-45	10	27	18	40.0	0.253
50	95.55	98.0	04B1-50	12	34	20	50.0	0.389
57	108.93	111.4	04B1-57	12	34	20	50.0	0.432
76	145.19	147.6	04B1-76	16	54	34	*80.0	1.511

All dimensions in mm.
 † Min. tolerance bore which can be machined in sprocket.
 * Sprockets with an asterisk on hub Ø may be of fabricated construction.

Sprockets up to 57 teeth manf. in min 600N/mm² UTS Steel, above 57 teeth in 410N/mm² UTS Steel.

Finished Bored and Keyed Sprockets

All standard plain bore sprockets can be supplied finish bored, with keyway and setscrews, all to customer specification. Where possible standard bores and keyways should always be used (refer to sizes shown on page 83). For idler applications sprockets can be supplied fitted with phosphor bronze bushes, or sintered bushes, with bores up to the maximum indicated for sprocket bore. All modifications are offered on our 48 hour rework service. Pinions with material to 600 N/mm² can have teeth induction hardened to 45Rc.