



PILOT BORE SPROCKETS - STAINLESS STEEL

Description

Stainless Steel pilot bore sprockets are manufactured to internationally recognised standards DIN8187-ISO/R 606 and are produced from 304L stainless steel.

Conveniently stocked with a minimum pilot bore (dimension 'D') they can be machined to suit any suitable mounting requirement. Available from stock to suit British standard roller chains from 06B (3/8" pitch) up to 16B (1" pitch) sizes in Simplex (single) row of teeth.

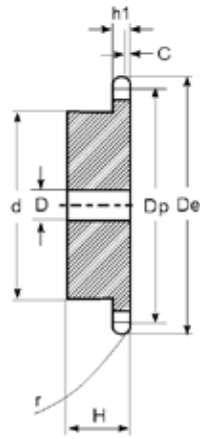

06B Chain

3/8" x 7/32"

Pitch: 9.525mm
Internal width: 5.72mm
Roller dia: 6.35mm

Sprocket

Tooth radius: 10mm
Radius width C: 1mm
Tooth width h1: 5.3mm

06B-1 (3SR) SS

Teeth	De	Dp	Part No.	d	D	H
12	40.00	36.80	3SR12-SS	25	8	25
13	43.00	39.80	3SR13-SS	28	10	25
14	46.30	42.80	3SR14-SS	31	10	25
15	49.30	45.81	3SR15-SS	34	10	25
16	52.30	48.82	3SR16-SS	37	10	28
17	55.30	51.83	3SR17-SS	40	10	28
18	58.30	54.85	3SR18-SS	43	10	28
19	61.30	57.87	3SR19-SS	45	10	28
20	64.30	60.89	3SR20-SS	46	10	28
21	68.00	63.91	3SR21-SS	48	12	28
22	71.00	66.93	3SR22-SS	50	12	28
23	73.50	69.95	3SR23-SS	52	12	28
24	77.00	72.97	3SR24-SS	54	12	28
25	80.00	76.00	3SR25-SS	57	12	28
26	83.00	79.02	3SR26-SS	60	12	28
27	86.00	82.04	3SR27-SS	60	12	28
28	89.00	85.07	3SR28-SS	60	12	28
29	92.00	88.09	3SR29-SS	60	12	28
30	94.70	91.12	3SR30-SS	60	12	28