

ST SERIES (ISO)

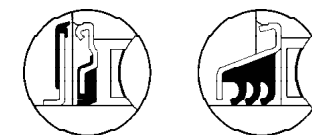
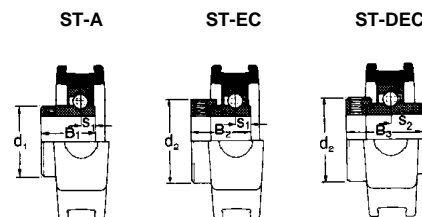
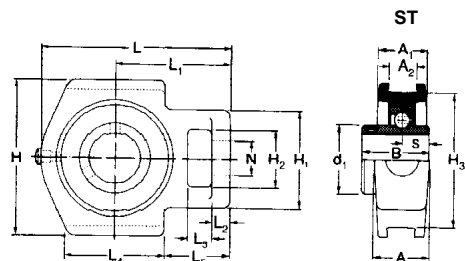

Bearing inserts with flinger seals shown on pages 91 and 92 can be fitted into these housings. The unit reference has the suffix 'FS'; e.g. ST45FS.

Triple seal bearing inserts shown on pages 88 to 90 can be fitted into these housings. The unit reference has a prefix 'T'; e.g. TST45.

Shaft diameter		RHP designation				Basic Casting Dimensions bearing group insert																												
mm	inches					L	L ₁	L ₂	L ₃	L ₄	L ₅	H	H ₁																					
														ISO load ratings		Rec. max. speed	Mass (approx.)																	
														dynamic	static	rev/min	kg																	
														C _r	C _{0r}																			
														newtons	newtons																			
														lbf	lbf		lb																	
20	3/4	ST20 ST3/4	ST20A ST3/4A	ST20EC ST3/4EC	ST20DEC ST3/4DEC	1020	2	96,5 3-760	62,0 2-441	11,5 -453	16,0 -630	50,5 1-988	36,5 1-437	88,5 3-484	58,5 2-303																			
25	7/8 15/16 1	ST25 ST7/8 ST15/16 ST1	ST25A ST7/8 ST15/16 ST1A	ST25EC ST7/8EC ST15/16EC ST1EC	ST25DEC ST7/8DEC ST15/16DEC ST1DEC	1025	3	98,0 3-858	62,0 2-441	11,5 -453	16,0 -630	50,5 1-988	36,5 1-437	88,5 3-484	58,5 2-303																			
30	11/8 1 3/16 1 1/4	ST30 ST11/8 ST1 3/16 ST1 1/4	ST30A ST11/8A ST1 3/16A ST1 1/4AR	ST30EC ST11/8EC ST1 3/16EC ST1 1/4ECR	ST30DEC ST11/8DEC ST1 3/16DEC ST1 1/4DEC	1030	4	115,5 4-547	71,7 2-823	12,5 -492	16,5 -650	64,5 2-539	43,0 1-693	101,5 3-996	64,5 2-539																			
35	1 1/4 1 3/8 1 7/16	ST35 ST1 1/4 ST1 3/8 ST1 7/16	ST35A ST1 1/4A ST1 3/8A ST1 7/16A	ST35EC ST1 1/4EC ST1 3/8EC ST1 7/16EC	ST35DEC ST1 1/4DEC ST1 3/8 DEC ST1 7/16 DEC	1035	5	124,0 4-882	75,5 2-972	12,5 -492	16,5 -650	64,5 2-539	43,0 1-693	101,5 3-996	64,5 2-539																			
40	1 1/2	ST40 ST1 1/2	ST40A ST1 1/2A	ST40EC ST1 1/2EC	ST40DEC ST1 1/2DEC	1040	6	143,5 5-650	89,2 3-512	15,5 -610	20,5 -807	81,5 3-209	50,5 1-988	118,0 4-646	82,5 3-248																			
45	1 5/8 1 11/16 1 3/4	ST45 ST1 5/8 ST1 11/16 ST1 3/4	ST45A ST1 5/8A ST1 11/16A ST1 3/4A	ST45EC ST1 5/8EC ST1 11/16EC ST1 3/4EC	ST45DEC ST1 5/8DEC ST1 11/16DEC ST1 3/4DEC	1045	7	147,0 5-787	89,2 3-512	15,5 -610	20,5 -807	81,5 3-209	50,5 1-988	118,0 4-646	82,5 3-248																			
50	1 7/8 1 15/16 2	ST50 ST1 7/8 ST1 15/16 ST2	ST50A ST1 7/8A ST1 15/16A ST2R	ST50EC ST1 7/8EC ST1 15/16EC	ST50DEC ST1 7/8DEC ST1 15/16DEC	1050	8	151,0 5-945	90,5 3-563	15,5 -610	20,5 -807	81,5 3-209	50,5 1-988	118,0 4-646	82,5 3-248																			
55	2 2 1/8 2 3/16	ST55 ST2 ST2 1/8 ST2 3/16			ST55DEC ST2DEC ST2 1/8DEC ST2 3/16DEC	1055	9	182,0 7-165	114,0 4-488	19,0 -748	32,0 1-260	97,5 3-839	70,0 2-756	146,0 5-748	101,0 3-976																			
60	2 1/4 2 3/8 2 7/16	ST60 ST2 1/4 ST2 3/8 ST2 7/16			ST60DEC ST2 1/4DEC ST2 3/8DEC ST2 7/16DEC	1060	10	192,0 7-559	119,0 4-685	19,0 -748	32,0 1-260	97,5 3-839	70,0 2-756	146,0 5-748	101,0 3-976																			
65																																		
70	2 1/2 2 11/16	ST65 ST70 ST2 1/2 ST2 11/16			ST65DEC ST70DEC ST2 1/2DEC ST2 11/16DEC	1070	11	222,5 8-760	137,5 5-413	21,5 -846	32,0 1-260	120,5 4-744	77,0 3-031	166,5 6-555	113,0 4-449																			
75	2 3/4 2 7/8 2 15/16	ST75 ST2 3/4 ST2 7/8 ST2 15/16			ST75DEC ST2 3/4DEC ST2 7/8DEC ST2 15/16DEC	1075	12	222,5 8-760	137,5 5-413	21,5 -846	32,0 1-260	120,5 4-744	77,0 3-031	166,5 6-555	113,0 4-449																			
80	3 3 3/16	ST80 ST3 ST3 3/16				1080	13	231,5 9-114	139,5 5-492	20,5 -807	32,0 1-260	125,0 4-921	74,0 2-913	184,0 7-244	113,0 4-449																			
85	3 1/4 3 3/8 3 7/16	ST85 ST3 1/4 ST3 3/8 ST3 7/16				1085	14	260,5 10-256	162,0 6-378	28,5 1-122	38,0 1-496	140,0 5-512	90,5 3-562	198,5 7-815	124,0 4-882																			

		Basic Casting Dimensions bearing group insert											ISO load ratings							Rec. max. speed	Mass (approx.)
H ₂	H ₃	N	A	A ₁	A ₂	B	B ₁	B ₂	B ₃	s	s ₁	s ₂	d ₁	d ₂	dynamic	static	rev/min	kg			
mm	inches														C _r	C _{0r}					
															newtons	newtons	rev/min	kg			
															lbf	lbf		lb			
32,0	76,0	22,5	36,0	27,5	13,50	30,96	25,77	30,92	43,62	12,75	7,56	17,12	28,50	33,30	12800	6580	6700	0,8			
1-260	2-992	-886	1-417	1-083	-531	1-219	1-015	1-217	1-717	-502	-298	-674	1-122	1-311	2880	1480	1-8				
32,0	76,0	22,5	36,0	27,5	13,50	34,11	27,35	30,92	44,40	14,32	7,56	17,49	34,01	38,10	14000	7880	6250	1,0			
1-260	2-992	-886	1-417	1-083	-531	1-343	1-077	1-217	1-748	-564	-298	-689	1-339	1-500	3150	1770	2,2				
37,5	89,0	22,5	36,5	30,0	13,50	38,10	31,21	35,68	48,42	15,93	9,04	18,32	40,00	44,45	19500	11300	5300	1,6			
1-476	3-504	-886	1-437	1-181	-531	1-500	1-229	1-405	1-906	-627	-356	-721	1-575	1-750	4380	2540	3,5				
37,5	89,0	22,5	36,5	30,0	13,50	42,88	34,90	38,88	51,18	17,53	9,55	18,89	46,69	55,58	25700	15300	4500	1,6			
1-476	3-504	-886	1-437	1-181	-531	1-688	1-374	1-531	2-015	-690	-376	-744	1-838	2-188	5780	3440	3,5				
49,5	101,0	29,0	49,5	37,0	17,50	49,23	41,18	43,64	56,34	19,10	11,05	21,46	52,70	60,30	29100	17900	4000	2,7			
1-949	3-976	-1142	1-949	1-457	-689	1-938	1-621	1-718	2-218	-752	-435	-845	2-075	2-374	6540	4020	6-0				
49,5	101,0	29,0	49,5	37,0	17,50	49,23	41,18	43,64	56,34	19,10	11,05	21,46	57,30	63,50	32500	20500	3700	2,8			
1-949	3-976	-1142	1-949	1-457	-689	1-938	1-621	1-718	2-218	-752	-435	-845	2-256	2-500	7310	4610	6-2				
49,5	101,0	29,0	49,5	37,0	17,50	51,59	43,54	43,64	62,70	19,10	11,05	24,65	62,20	69,85	35000	23200	3400	2,8			
1-949	3-976	-1142	1-949	1-457	-689	2-031	1-714	1-718	2-469	-752	-435	-970	2-449	2-750	7870	5220	6-2				
64,0	130,0	35,0	63,5	46,5	27,00	55,55	-	-	71,44	22,28	-	27,82	68,81	76,20	43500	29200	3100	4,2			
2-520	5-118	-1-378	2-500	1-831	-1-063	2-187	-	-	2-813	-877	-	1-095	2-709	3-000	9780	6560	9-3				
64,0	130,0	35,0	63,5	46,5	27,00	65,07	-	-	77,82	25,45	-	31,02	75,34	84,12	52500	35900	2800	5,4			
2-520	5-118	-1-378	2-500	1-831	-1-063	2-562	-	-	3-064	-1-002	-	1-221	2-996	3-312	11800	8070	11-8				
70,0	150,8	42,0	70,0	50,5	27,00	74,63	-	-	85,36	30,23	-	34,19	87,00	96,82	62000	44000	2450	7,9			
2-756	5-937	-1-654	2-756	1-988	-1-063	2-938	-	-	3-361	-1-190	-	1-346	3-425	3-812	13940	9890	17-5				
70,0	150,8	42,0	70,0	50,5	27,00	77,77	-	-	91,72	33,37	-	37,37	92,00	101,60	66000	49300	2300	8,4			
2-756	5-937	-1-654	2-756	1-988	-1-063	3-062	-	-	3-611	-1-314	-	1-471	3-622	4-000	14840	11080	18-5				
70,0	165,1	42,0	70,0	54,0	27,00	82,55	-	-	98,50	-	-	98,50	-	-	72500	53000	2150	9,0			
2-756	6-500	-1-654	2-756	2-126	-1-063	3-250	-	-	-	-	-	-	-	-	16300	11910	19-9				
73,0	173,0	47,5	79,5	68,5	46,05	85,72	-	-	98,50	-	-	106,02	-	-	83500	63800	2000	13,7			
2-874	6-811	-1-870	3-130	2-697	-1-813	3-375	-	-	1-346	-	-	4-174	-	-	18770	14340	30-2				

Please check availability