



# MOTOR DATA SHEET

**MOTOR PART CODE:**

**30.023TECAB3-IE2**

**FRAME SIZE:**

**200L1-2**

	50Hz
Output (kW)	30
Rotation Speed (rpm)	2950
Voltage	400/690
Full Load Current (A)	51.72   29.86
Full Load Torque (Nm)	97.11864407

	60Hz
Output (kW)	36
Rotation Speed (rpm)	3540
Voltage	480   828
Full Load Current (A)	51.72   29.86
Full Load Torque (Nm)	80.93

## Efficiency Data

100%	75%	50%
92	91.4	89.3

Factory Reference	MS2 200L1-2
Tst/Tn (times)	2.5
Tmax/Tn	3.3
Noise (dB)	94
Moment of inertia	0.1222455
Type of feet	Removable feet
Protection	IP55
Rotation Direction	F / R
Cable Glands	2 - M40× 1.5
Paint Colour	RAL 7024
Efficiency	IE2
Bearing (DE)	6312 2RS C3

Power Factor (cos)	0.91
Tmin/Tn	1.3
Ist/In (Times)	8.8
Net Weight (Kg)	158
Housing material	Aluminum
Insulation Class	F
Thermal Protection	PTC 130°C
Duty Cycle	S1
Cooling	IC411
Ambient Temperature	-20°C to + 40°C
Bearing Brand	NSK
Bearing (NDE)	6212 2RS C3

*Motors designed and manufactured in accordance with:*

**IEC 60034  
IEC 60038  
IEC 60072  
2014/30/EU (EMC)  
2014/35/EU (LVD)  
2011/65/EU (RoHS 2)**

[www.tecmotors.co.uk](http://www.tecmotors.co.uk)

TEC Electric Motors Ltd. reserves the right to amend or change motor designs or data sheet information

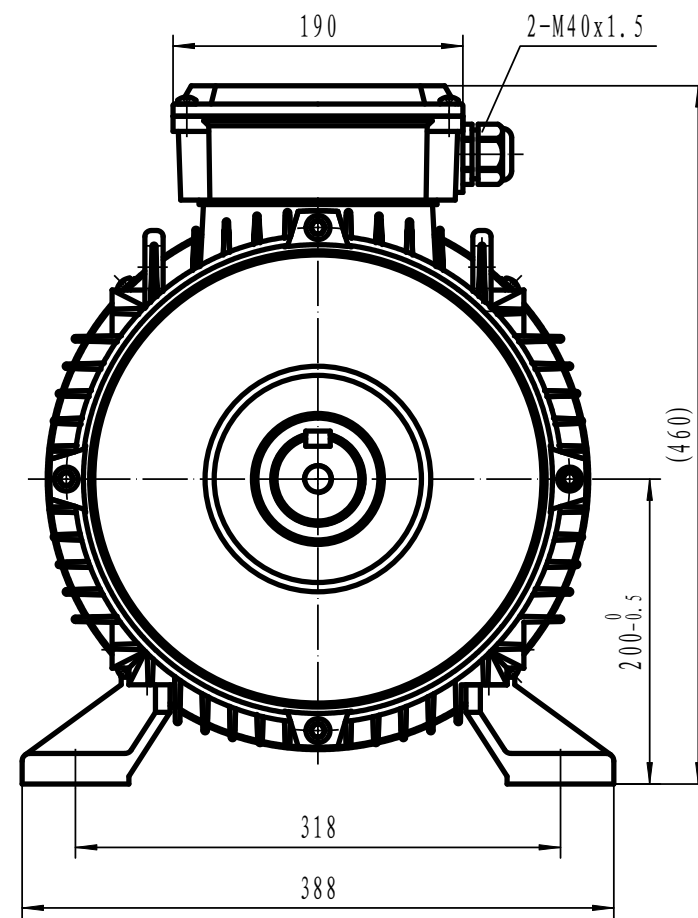
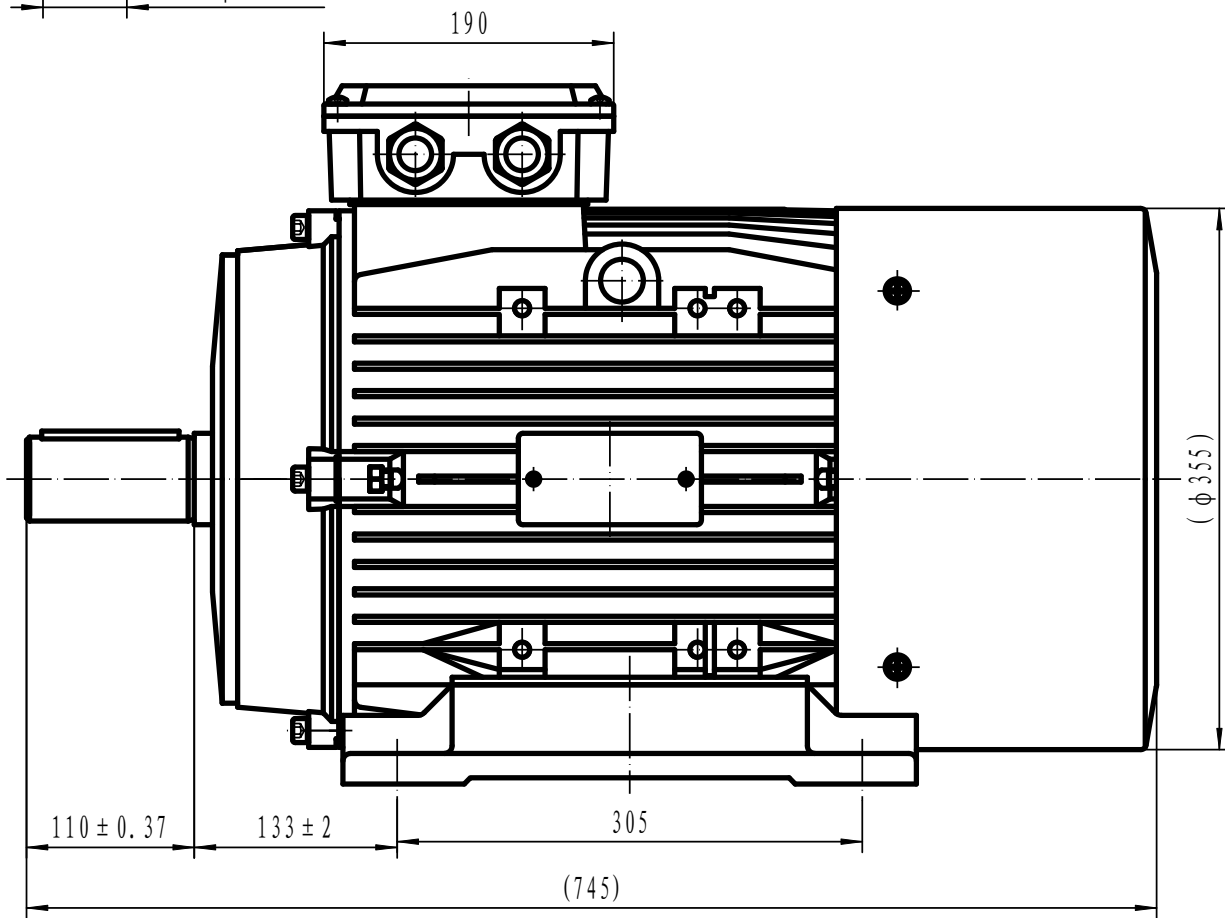
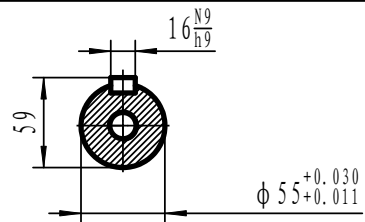

Drawn By	Date
TECHTOP	27/11/2017
Approved by	Date
L. Overton	27/11/2017
Issue No =	Date
001/A	27/11/2017

**TECA 200 B3**

