

Pulleys for Metric Polyurethane AT10 Belts

Pulley Types

The Pulley types referred to in tables are as drawings below. Suffix 'F' indicates pulley has flanges.

Std. Pulleys can be reworked to customers bore and keywaying requirements.

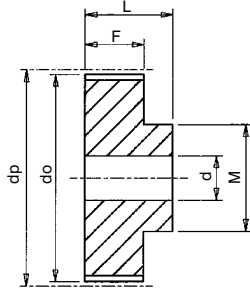

Type 1

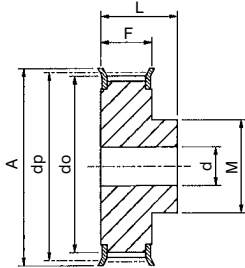

Type 1F

All pulleys machined from aluminium for low weight and inertia, and fitted as indicated with steel flanges.
All dimensions in mm

| Catalogue No. | No. Teeth Z | Pulley Type | Pitch Circle Dia. dp | Min. Bore d | Max. Bore d | Outside Diameter do | Flange Dia. A | Pulley Width F | Bore Length L | Hub Dia. M | Approx. Weight kg |
|-----------------------------------------------------------|-------------|-------------|----------------------|-------------|-------------|---------------------|---------------|----------------|---------------|------------|-------------------|
| 10mm Pitch Pulleys for 16mm Wide Belt Ref. 16AT10 | | | | | | | | | | | |
| 16 AT10-15 | 15 | 1F | 47.75 | 8 | 20 | 45.9 | 51 | 21 | 31 | 31 | 0.12 |
| 16 AT10-16 | 16 | 1F | 50.93 | 8 | 23 | 49.1 | 54 | 21 | 31 | 35 | 0.14 |
| 16 AT10-18 | 18 | 1F | 57.30 | 8 | 26 | 55.4 | 60 | 21 | 31 | 40 | 0.17 |
| 16 AT10-19 | 19 | 1F | 60.48 | 8 | 28 | 58.6 | 66 | 21 | 31 | 44 | 0.19 |
| 16 AT10-20 | 20 | 1F | 63.66 | 8 | 30 | 61.8 | 66 | 21 | 31 | 46 | 0.21 |
| 16 AT10-22 | 22 | 1F | 70.03 | 8 | 34 | 68.2 | 75 | 21 | 31 | 52 | 0.26 |
| 16 AT10-24 | 24 | 1F | 76.39 | 8 | 38 | 74.5 | 83 | 21 | 31 | 58 | 0.29 |
| 16 AT10-25 | 25 | 1F | 79.58 | 8 | 39 | 77.7 | 83 | 21 | 31 | 60 | 0.31 |
| 16 AT10-26 | 26 | 1F | 82.76 | 8 | 39 | 80.9 | 87 | 21 | 31 | 60 | 0.36 |
| 16 AT10-27 | 27 | 1F | 85.94 | 8 | 39 | 84.1 | 91 | 21 | 31 | 60 | 0.37 |
| 16 AT10-28 | 28 | 1F | 89.13 | 8 | 39 | 87.2 | 93 | 21 | 31 | 60 | 0.40 |
| 16 AT10-30 | 30 | 1F | 95.49 | 8 | 39 | 93.6 | 97 | 21 | 31 | 60 | 0.44 |
| 16 AT10-32 | 32 | 1F | 101.86 | 10 | 42 | 100.0 | 106 | 21 | 31 | 65 | 0.49 |
| 16 AT10-36 | 36 | 1F | 114.59 | 10 | 45 | 112.7 | 120 | 21 | 31 | 70 | 0.63 |
| 16 AT10-40 | 40 | 1F | 127.32 | 10 | 52 | 125.4 | 135 | 21 | 31 | 80 | 0.77 |
| 16 AT10-44 | 44 | 1 | 140.06 | 10 | 57 | 138.2 | - | 21 | 31 | 88 | 1.00 |
| 16 AT10-48 | 48 | 1 | 152.79 | 16 | 62 | 150.9 | - | 21 | 31 | 95 | 1.09 |
| 16 AT10-60 | 60 | 1 | 190.99 | 16 | 72 | 189.1 | - | 21 | 31 | 110 | 1.70 |
| 10mm Pitch Pulleys for 25mm Wide Belt Ref. 25AT10 | | | | | | | | | | | |
| 25 AT10-15 | 15 | 1F | 47.75 | 8 | 21 | 45.9 | 51 | 30 | 40 | 32 | 0.16 |
| 25 AT10-16 | 16 | 1F | 50.93 | 8 | 23 | 49.1 | 54 | 30 | 40 | 35 | 0.18 |
| 25 AT10-18 | 18 | 1F | 57.30 | 8 | 26 | 55.4 | 60 | 30 | 40 | 40 | 0.23 |
| 25 AT10-19 | 19 | 1F | 60.48 | 8 | 28 | 58.6 | 66 | 30 | 40 | 44 | 0.25 |
| 25 AT10-20 | 20 | 1F | 63.66 | 8 | 30 | 61.8 | 66 | 30 | 40 | 46 | 0.28 |
| 25 AT10-22 | 22 | 1F | 70.03 | 8 | 34 | 68.2 | 75 | 30 | 40 | 52 | 0.34 |
| 25 AT10-24 | 24 | 1F | 76.39 | 8 | 38 | 74.5 | 83 | 30 | 40 | 58 | 0.39 |
| 25 AT10-25 | 25 | 1F | 79.58 | 8 | 39 | 77.7 | 83 | 30 | 40 | 60 | 0.42 |
| 25 AT10-26 | 26 | 1F | 82.76 | 8 | 39 | 80.9 | 87 | 30 | 40 | 60 | 0.48 |
| 25 AT10-27 | 27 | 1F | 85.94 | 8 | 39 | 84.1 | 91 | 30 | 40 | 60 | 0.54 |
| 25 AT10-28 | 28 | 1F | 89.13 | 8 | 39 | 87.2 | 93 | 30 | 40 | 60 | 0.55 |
| 25 AT10-30 | 30 | 1F | 95.49 | 8 | 39 | 93.6 | 97 | 30 | 40 | 60 | 0.64 |
| 25 AT10-32 | 32 | 1F | 101.86 | 10 | 42 | 100.0 | 106 | 30 | 40 | 65 | 0.69 |
| 25 AT10-36 | 36 | 1F | 114.59 | 10 | 45 | 112.7 | 120 | 30 | 40 | 70 | 0.87 |
| 25 AT10-40 | 40 | 1F | 127.32 | 10 | 52 | 125.4 | 135 | 30 | 40 | 80 | 1.07 |
| 25 AT10-44 | 44 | 1 | 140.06 | 10 | 57 | 138.2 | - | 30 | 40 | 88 | 1.35 |
| 25 AT10-48 | 48 | 1 | 152.79 | 16 | 62 | 150.9 | - | 30 | 40 | 95 | 1.52 |
| 25 AT10-60 | 60 | 1 | 190.99 | 16 | 72 | 189.1 | - | 30 | 40 | 110 | 2.34 |
| 10mm Pitch Pulleys for 32mm Wide Belt Ref. 32AT10- | | | | | | | | | | | |
| 32 AT10-18 | 18 | 1F | 57.30 | 10 | 26 | 55.4 | 60 | 37 | 47 | 40 | 0.26 |
| 32 AT10-19 | 19 | 1F | 60.48 | 10 | 28 | 58.6 | 66 | 37 | 47 | 44 | 0.28 |
| 32 AT10-20 | 20 | 1F | 63.66 | 12 | 30 | 61.8 | 66 | 37 | 47 | 46 | 0.32 |
| 32 AT10-22 | 22 | 1F | 70.03 | 12 | 34 | 68.2 | 75 | 37 | 47 | 52 | 0.40 |
| 32 AT10-24 | 24 | 1F | 76.39 | 12 | 38 | 74.5 | 83 | 37 | 47 | 58 | 0.48 |
| 32 AT10-25 | 25 | 1F | 79.58 | 12 | 39 | 77.7 | 83 | 37 | 47 | 60 | 0.53 |
| 32 AT10-26 | 26 | 1F | 82.76 | 12 | 39 | 80.9 | 87 | 37 | 47 | 60 | 0.57 |
| 32 AT10-27 | 27 | 1F | 85.94 | 12 | 39 | 84.1 | 91 | 37 | 47 | 60 | 0.60 |
| 32 AT10-28 | 28 | 1F | 89.13 | 12 | 39 | 87.2 | 93 | 37 | 47 | 60 | 0.64 |
| 32 AT10-30 | 30 | 1F | 95.49 | 12 | 39 | 93.6 | 97 | 37 | 47 | 60 | 0.74 |
| 32 AT10-32 | 32 | 1F | 101.86 | 12 | 42 | 100.0 | 106 | 37 | 47 | 65 | 0.85 |
| 32 AT10-36 | 36 | 1F | 114.59 | 16 | 45 | 112.7 | 120 | 37 | 47 | 70 | 1.07 |
| 32 AT10-40 | 40 | 1F | 127.32 | 16 | 52 | 125.4 | 135 | 37 | 47 | 80 | 1.32 |
| 32 AT10-44 | 44 | 1 | 140.06 | 16 | 57 | 138.2 | - | 37 | 47 | 88 | 1.61 |
| 32 AT10-48 | 48 | 1 | 152.79 | 16 | 62 | 150.9 | - | 37 | 47 | 95 | 1.93 |
| 32 AT10-60 | 60 | 1 | 190.99 | 16 | 72 | 189.1 | - | 37 | 47 | 110 | 3.00 |
| 10mm Pitch Pulleys for 50mm Wide Belt Ref. 50AT10 | | | | | | | | | | | |
| 50 AT10-18 | 18 | 1F | 57.30 | 10 | 26 | 55.4 | 60 | 56 | 66 | 40 | 0.43 |
| 50 AT10-19 | 19 | 1F | 60.48 | 10 | 28 | 58.6 | 66 | 56 | 66 | 44 | 0.47 |
| 50 AT10-20 | 20 | 1F | 63.66 | 12 | 30 | 61.8 | 66 | 56 | 66 | 46 | 0.52 |
| 50 AT10-22 | 22 | 1F | 70.03 | 12 | 34 | 68.2 | 75 | 56 | 66 | 52 | 0.57 |
| 50 AT10-24 | 24 | 1F | 76.39 | 12 | 38 | 74.5 | 83 | 56 | 66 | 58 | 0.74 |
| 50 AT10-25 | 25 | 1F | 79.58 | 12 | 39 | 77.7 | 83 | 56 | 66 | 60 | 0.77 |
| 50 AT10-26 | 26 | 1F | 82.76 | 12 | 39 | 80.9 | 87 | 56 | 66 | 60 | 0.82 |
| 50 AT10-27 | 27 | 1F | 85.94 | 12 | 39 | 84.1 | 91 | 56 | 66 | 60 | 0.91 |
| 50 AT10-28 | 28 | 1F | 89.13 | 12 | 39 | 87.2 | 93 | 56 | 66 | 60 | 0.96 |
| 50 AT10-30 | 30 | 1F | 95.49 | 12 | 39 | 93.6 | 97 | 56 | 66 | 60 | 1.17 |
| 50 AT10-32 | 32 | 1F | 101.86 | 12 | 42 | 100.0 | 106 | 56 | 66 | 65 | 1.30 |
| 50 AT10-36 | 36 | 1F | 114.59 | 16 | 45 | 112.7 | 120 | 56 | 66 | 70 | 1.64 |
| 50 AT10-40 | 40 | 1F | 127.32 | 16 | 52 | 125.4 | 135 | 56 | 66 | 80 | 2.00 |
| 50 AT10-44 | 44 | 1 | 140.06 | 16 | 57 | 138.2 | - | 56 | 66 | 88 | 2.36 |
| 50 AT10-48 | 48 | 1 | 152.79 | 16 | 62 | 150.9 | - | 56 | 66 | 95 | 2.83 |
| 50 AT10-60 | 60 | 1 | 190.99 | 16 | 72 | 189.1 | - | 56 | 66 | 110 | 4.37 |

Pulley Installation

Correct and accurate installation of Timing Drives is essential. Pulley alignment and shaft parallelism is very important as misalignment of the drive will cause unequal loading across the belt width and edge wear of belt on flanges. Pulley alignment can be checked by placing a straight edge against the outside edge of the pulleys and adjusting so contact made evenly across both pulleys.

The shafts should be located within a rigid framework, as any distortion under load could result in a reduction of centre distance which will cause jumping of belt on pulley teeth. If idlers are used they must be locked firmly into position after correct belt tensioning. Refer to page 10 for additional information on drive installation.