

Pulleys for Metric Polyurethane AT 5 Belts

AT Series Timing Pulleys

Designed to complete the power Transmission package for the enhanced power 'AT' series belts, are the Cross pilot bore stock pulleys for AT5 and AT10 belt drives.

The 'AT' series belts provide increased power capacity in a Polyurethane belt by increasing the belt tooth size and also the tension members.

The increased tooth width of AT series belts increases both the strength and stiffness of the tooth improving meshing with the pulley's also the longer flat surface of the teeth enables better transmission of radial loads.

Higher strength tension members improve pitch accuracy along with increasing the tensile strength of the belt, which combined with the stronger teeth enables increase in power transmitted by approx 50% over the 'T' series belts.

The 'AT' belt design provides improved accuracy in linear drives, with reduced backlash when using standard pulleys. The longer tooth reduces polygon effect which combined with the opportunity to reduce belt width enables reduction in noise levels.

Cross offer AT5 and AT10 pulleys as standard, but can also manufacture to customers design including AT20.

Catalogue No.	No. Teeth Z	Pulley Type	Pitch Circle Diameter dp	Min. Bore d	Max Bore d	Outside Diameter do	Flange Diameter A	Pulley Width F	Bore Length L	Hub Diameter M	Approx. Weight kg
5mm Pitch Pulleys for 10mm Wide Belt Ref. 10AT 5											
10AT5-12	12	1F	19.10	4	7	18.2	23.0	15	21	11	.016
10AT5-14	14	1F	22.28	4	9	21.4	25.0	15	21	14	.019
10AT5-15	15	1F	23.87	6	10	23.0	28.0	15	21	16	.021
10AT5-16	16	1F	25.46	6	11	24.6	32.0	15	21	18	.025
10AT5-18	18	1F	28.65	6	13	27.8	32.0	15	21	20	.031
10AT5-19	19	1F	30.24	6	14	29.4	36.0	15	21	22	.036
10AT5-20	20	1F	31.83	6	15	31.0	36.0	15	21	23	.038
10AT5-22	22	1F	35.01	6	15	34.1	38.0	15	21	24	.046
10AT5-24	24	1F	38.20	6	17	37.4	42.0	15	21	26	.054
10AT5-25	25	1F	39.79	6	17	38.9	44.0	15	21	26	.058
10AT5-26	26	1F	41.38	6	17	40.6	44.0	15	21	26	.062
10AT5-27	27	1F	42.97	8	19	42.2	48.0	15	21	30	.064
10AT5-28	28	1F	44.56	8	20	43.7	48.0	15	21	32	.071
10AT5-30	30	1F	47.75	8	22	46.9	51.0	15	21	34	.075
10AT5-32	32	1F	50.93	8	23	50.1	54.0	15	21	36	.088
10AT5-36	36	1F	57.30	8	24	56.4	64.0	15	21	38	.114
10AT5-40	40	1F	63.66	8	26	62.8	66.5	15	21	40	.138
10AT5-42	42	1F	66.84	8	26	66.0	70.0	15	21	40	.153
10AT5-44	44	1	70.03	8	29	69.2	-	15	21	45	.170
10AT5-48	48	1	76.39	8	32	75.5	-	15	21	50	.200
10AT5-60	60	1	95.49	8	42	94.6	-	15	21	65	.308
5mm Pitch Pulleys for 16mm Wide Belt Ref. 16AT 5											
16AT5-12	12	1F	19.10	4	7	18.2	23.0	21	27	11	.022
16AT5-14	14	1F	22.28	4	9	21.4	25.0	21	27	14	.027
16AT5-15	15	1F	23.87	6	10	23.0	28.0	21	27	16	.030
16AT5-16	16	1F	25.46	6	11	24.6	32.0	21	27	18	.036
16AT5-18	18	1F	28.65	6	13	27.8	32.0	21	27	20	.044
16AT5-19	19	1F	30.24	6	14	29.4	36.0	21	27	22	.050
16AT5-20	20	1F	31.83	6	15	31.0	36.0	21	27	23	.054
16AT5-22	22	1F	35.01	6	15	34.1	38.0	21	27	24	.055
16AT5-24	24	1F	38.20	6	17	37.4	42.0	21	27	26	.077
16AT5-25	25	1F	39.79	6	17	38.9	44.0	21	27	26	.082
16AT5-26	26	1F	41.38	6	17	40.6	44.0	21	27	26	.086
16AT5-27	27	1F	42.97	8	19	42.2	48.0	21	27	30	.092
16AT5-28	28	1F	44.56	8	20	43.7	48.0	21	27	32	.094
16AT5-30	30	1F	47.75	8	22	46.9	51.0	21	27	34	.106
16AT5-32	32	1F	50.93	8	23	50.1	54.0	21	27	36	.124
16AT5-36	36	1F	57.30	8	24	56.4	64.0	21	27	38	.160
16AT5-40	40	1F	63.66	8	26	62.8	66.5	21	27	40	.195
16AT5-42	42	1F	66.84	8	26	66.0	70.0	21	27	40	.206
16AT5-44	44	1	70.03	8	29	69.2	-	21	27	45	.230
16AT5-48	48	1	76.39	8	32	75.5	-	21	27	50	.282
16AT5-60	60	1	95.49	8	42	94.6	-	21	27	65	.432
5mm Pitch Pulleys for 25mm Wide Belt Ref. 25AT 5											
25AT5-12	12	1F	19.10	4	7	18.2	23.0	30	36	11	.032
25AT5-14	14	1F	22.28	4	9	21.4	25.0	30	36	14	.038
25AT5-15	15	1F	23.87	6	10	23.0	28.0	30	36	16	.042
25AT5-16	16	1F	25.46	6	11	24.6	32.0	30	36	18	.052
25AT5-18	18	1F	28.65	6	13	27.8	32.0	30	36	20	.063
25AT5-19	19	1F	30.24	6	14	29.4	36.0	30	36	22	.072
25AT5-20	20	1F	31.83	6	15	31.0	36.0	30	36	23	.078
25AT5-22	22	1F	35.01	6	15	34.1	38.0	30	36	24	.082
25AT5-24	24	1F	38.20	8	17	37.4	42.0	30	36	26	.110
25AT5-25	25	1F	39.79	8	17	38.9	44.0	30	36	26	.117
25AT5-26	26	1F	41.38	8	17	40.6	44.0	30	36	26	.121
25AT5-27	27	1F	42.97	8	19	42.2	48.0	30	36	30	.123
25AT5-28	28	1F	44.56	8	20	43.7	48.0	30	36	32	.127
25AT5-30	30	1F	47.75	8	22	46.9	51.0	30	36	34	.152
25AT5-32	32	1F	50.93	8	23	50.1	54.0	30	36	36	.177
25AT5-36	36	1F	57.30	8	24	56.4	64.0	30	36	38	.232
25AT5-40	40	1F	63.66	8	26	62.8	66.5	30	36	40	.278
25AT5-42	42	1F	66.84	8	26	66.0	70.0	30	36	40	.296
25AT5-44	44	1	70.03	8	29	69.2	-	30	36	45	.327
25AT5-48	48	1	76.39	8	32	75.5	-	30	36	50	.402
25AT5-60	60	1	95.49	8	42	94.6	-	30	36	65	.617

Pulley Types

The Pulley types referred to in tables are as drawings below. Suffix 'F' indicates pulley has flanges.

Std. Pulleys can be reworked to customers bore and keywaying requirement.

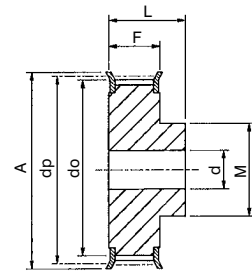

Type 1F

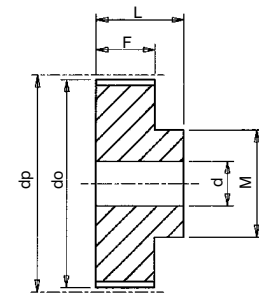

Type 1

All pulleys machined from aluminium for low weight and inertia, and fitted as indicated with steel flanges. All dimensions in mm