

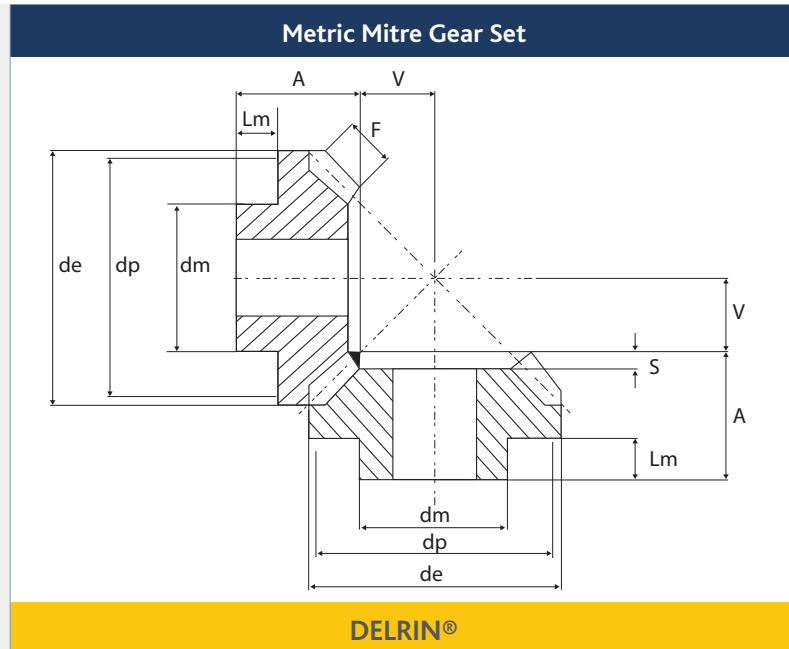

Metric Moulded Mitre Gear Sets, in DELRIN® 500, 0.5 - 1.5 MOD



- Intermediate sizes and special mitres to drawing (tooling charges may apply)
- Standard tolerances, unless otherwise stated ± 0.25 mm
- Shaft axis to intersect within ± 0.025 mm
- Angular accuracy between shafts ± 5 mins
- Mounting distance tolerance ± 0.05 mm
- Bore tolerance $-0.02 / -0.04$
- Max. recommended working temperature 90°C
- 20° pressure angle
- Supplied in pairs
- All dimensions in mm
- Moulded DELRIN® 500 to gear quality AGMA 7

Code	Pitch module	No. teeth	Bore	dp (mm)	de (mm)	F (mm)	A + V (mm)	dm (mm)	Lm (mm)	S (mm)	A (mm)
DBM05/20	0.5	20	3	10	10.71	2.5	11	8	4	0.97	7.97
DBM08/20	0.8	20	5	16	17.13	3.5	16	12	5	0.8	10.83
DBM10/20	1	20	6	20	21.41	4.5	21	16	7	1.62	14.62
DBM15/20	1.5	20	8	30	32.12	7	30	20	10	1.6	20.59

Sintered Bronze Bushes type OB

Code	Bore \varnothing (mm)	Outside \varnothing D (mm)	Length F (mm)	Use with
OB357	3	5	7	DBM08
OB469	4	6	9	DBM10
OB5814	5	8	14	DBM15

- Intermediate sizes and special bushes to drawing (tooling charges may apply)
- All dimensions in mm
- Bore tolerance G7
- OD tolerance s7
- Length tolerance js13

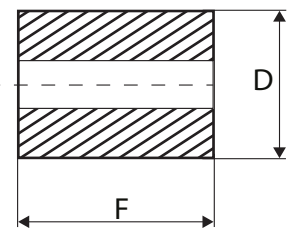

Please note: All dimensions subject to change. If a dimension is critical to your application please contact our Sales Department for confirmation. For special or reworked gears please contact our Manufacturing Department for a quotation.