

# TAPER BUSH LOCKING DEVICE

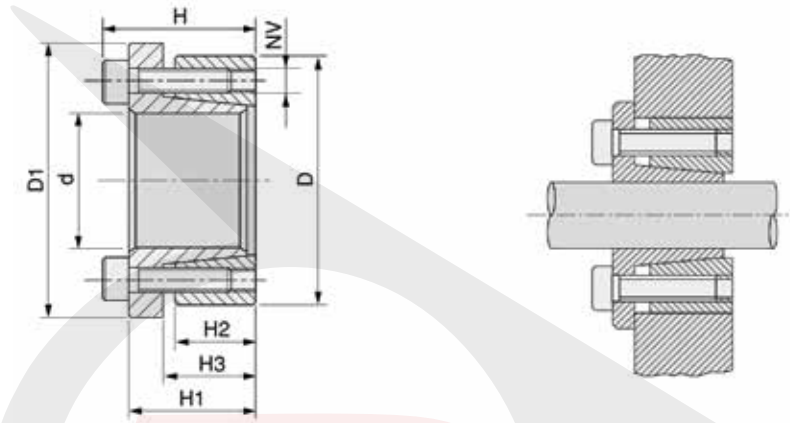

## DLK134 SECTION

Part No.	Dimensions							Tightening			Loosening		Performances		Surface Pressure	
	d	D	D1	H	H1	H2	H3	NV	Tv (Nm)	No. of screws	NV	No. of screws	Mt (mm)	Ta (KN)	Pa (N/mm <sup>2</sup> )	Pm (N/mm <sup>2</sup> )
DLK134-114	14	55	62	39	31	17	22	M8x25	37	4	M8x25	2	234	33	415	106
DLK134-116	16	55	62	39	31	17	22	M8x25	37	4	M8x25	2	268	33	363	106
DLK134-118	18	55	62	39	31	17	22	M8x25	41	4	M8x25	2	333	37	357	117
DLK134-119	19	55	62	39	31	17	22	M8x25	41	4	M8x25	2	352	37	338	117
DLK134-120	20	55	62	39	31	17	22	M8x25	41	4	M8x25	2	370	37	321	117
DLK134-122	22	55	62	39	31	17	22	M8x25	41	4	M8x25	2	407	37	292	117
DLK134-124	24	55	62	39	31	17	22	M8x25	41	4	M8x25	2	445	37	268	117
DLK134-125	25	55	62	39	31	17	22	M8x25	41	4	M8x25	2	463	37	257	117
DLK134-128	28	55	62	39	31	17	22	M8x25	41	4	M8x25	2	519	37	229	117
DLK134-130	30	55	62	39	31	17	22	M8x25	41	4	M8x25	2	556	37	214	117
DLK134-224	24	65	72	39	31	17	22	M8x25	41	5	M8x25	3	556	46	335	124
DLK134-225	25	65	72	39	31	17	22	M8x25	41	5	M8x25	3	579	46	321	124
DLK134-228	28	65	72	39	31	17	22	M8x25	41	5	M8x25	3	649	46	287	124
DLK134-230	30	65	72	39	31	17	22	M8x25	41	5	M8x25	3	695	46	268	124
DLK134-232	32	65	72	39	31	17	22	M8x25	41	5	M8x25	3	741	46	251	124
DLK134-233	33	65	72	39	31	17	22	M8x25	41	5	M8x25	3	764	46	242	124
DLK134-235	35	65	72	39	31	17	22	M8x25	41	5	M8x25	3	811	46	230	124
DLK134-238	38	65	72	39	31	17	22	M8x25	41	5	M8x25	3	917	46	211	124
DLK134-240	40	65	72	39	31	17	22	M8x25	41	5	M8x25	3	966	46	201	124
DLK134-330	30	80	87	41	33	20	25	M8x25	41	7	M8x25	3	972	65	318	119
DLK134-332	32	80	87	41	33	20	25	M8x25	41	7	M8x25	3	1037	65	299	119
DLK134-333	33	80	87	41	33	20	25	M8x25	41	7	M8x25	3	1069	65	289	119
DLK134-335	35	80	87	41	33	20	25	M8X25	41	7	M8X25	3	1134	65	273	119

## DLK134 SECTION continued

Part No.	Dimensions							Tightening			Loosening		Performances		Surface Pressure	
	d	D	D1	H	H1	H2	H3	NV	Tv (Nm)	No. of screws	NV	No. of screws	Mt (mm)	Ta (KN)	Pa (N/mm <sup>2</sup> )	Pm (N/mm <sup>2</sup> )
DLK134-338	38	80	87	41	33	20	25	M8X25	41	7	M8X25	3	1231	65	251	119
DLK134-340	40	80	87	41	33	20	25	M8X25	41	7	M8X25	3	1296	65	239	119
DLK134-342	42	80	87	41	33	20	25	M8X25	41	7	M8X25	3	1361	65	227	119
DLK134-345	45	80	87	41	33	20	25	M8X25	41	7	M8X25	3	1458	65	212	119
DLK134-348	48	80	87	41	33	20	25	M8X25	41	7	M8X25	3	1555	65	199	119
DLK134-350	50	80	87	41	33	20	25	M8X25	41	7	M8X25	3	1620	65	191	116