

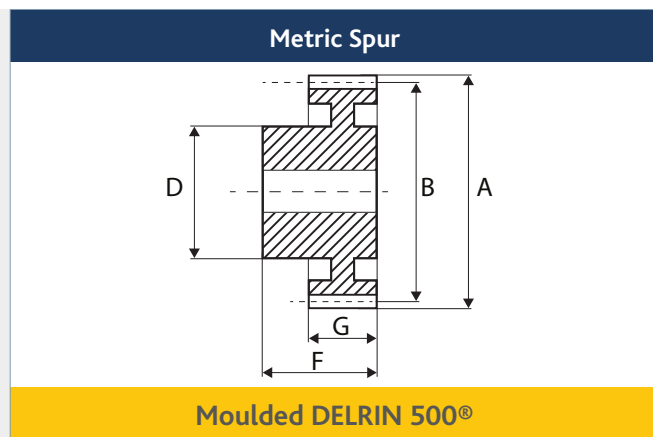

Metric Spur Gears in Moulded DELRIN® 500, 0.8 MOD, 20° P.A



- Intermediate sizes and special gears to drawing (tooling charges may apply)
- Standard tolerances, unless otherwise stated $\pm 0.25\text{mm}$
- All dimensions in mm
- Moulded DELRIN® 500 to gear quality AGMA 7

Code	No. teeth	Pitch \varnothing B	Bore (-0.02 / -0.04)	Hub/Boss \varnothing D	Outside \varnothing A	O/A width F	Face width G
DS08/12B	12	9.6	3	6	11.2	9	4
DS08/15B	15	12	3	6	13.6	9	4
DS08/16B	16	12.8	4	8	14.4	9	4
DS08/18B	18	14.4	4	8	16	9	4
DS08/20B	20	16	5	10	17.6	9	4
DS08/24B	24	19.2	5	10	20.8	9	4
DS08/25B	25	20	5	10	21.6	9	4
DS08/28B	28	22.4	5	10	24	9	4
DS08/30B	30	24	6	12	25.6	9	4
DS08/32B	32	25.6	6	12	27.2	9	4
DS08/35B	35	28	6	12	29.6	9	4
DS08/36B	36	28.8	6	12	30.4	9	4
DS08/40B	40	32	6	12	33.6	9	4
DS08/48B	48	38.4	6	14.5	40	10	4
DS08/50B	50	40	6	14.5	41.6	10	4
DS08/56B	56	44.8	6	14.5	46.4	10	4
DS08/60B	60	48	6	14.5	49.6	10	4
DS08/64B	64	51.2	6	15.5	52.8	10	4
DS08/70B	70	56	6	15.5	57.6	10	4
DS08/72B	72	57.6	6	15.5	59.2	10	4
DS08/80B	80	64	6	15.5	65.6	10	4

Sintered Bronze Bushes type OB

Code	Bore \varnothing (mm)	Outside \varnothing D (mm)	Length F (mm)	Use with
OB368	3	6	8	DS08
OB469	4	6	9	DS08

- Intermediate sizes and special bushes to drawing (tooling charges may apply)
- All dimensions in mm
- Bore tolerance G7
- OD tolerance s7
- Length tolerance js13

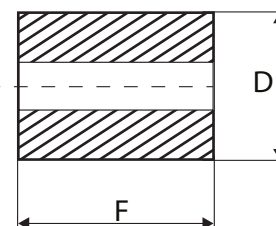

Please note: All dimensions subject to change. If a dimension is critical to your application please contact our Sales Department for confirmation. For special or reworked gears please contact our Manufacturing Department for a quotation.