

Flange Units (Square)

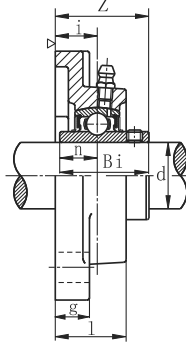

TRL type seal

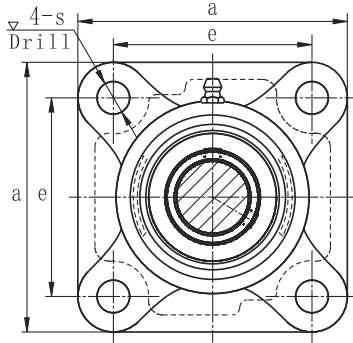

SR type seal

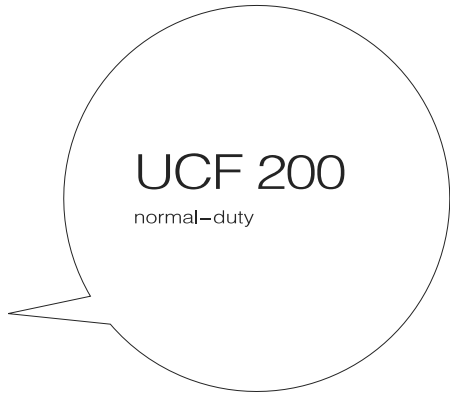

UCF 200

normal-duty

Bearing unit	Shaft Dia.	Dimensions(in)or(mm)										Bolt used	Bearing	Housing	Weight		
No.	d	a	e	i	g	l	s	Z	Bi	n	No.	No.					
	(in.) (mm)										(mm) (in.)		(kg)				
UCF 201 201-8	1/2	12	3 3/8 86	33/64 64	19/32 15	15/32 12	1	25.5	15/32 12	5/16 33.3	1.2205 31.0	0.5000 12.7	M10	3/8	UC 201 201-8	F 201	0.63
UCF 202 202-10	5/8	15	3 3/8 86	33/64 64	19/32 15	15/32 12	1	25.5	15/32 12	5/16 33.3	1.2205 31.0	0.5000 12.7	M10	3/8	UC 202 202-10	F 202	0.63
UCF 203 203-11	11/16	17	3 3/8 86	33/64 64	19/32 15	15/32 12	1	25.5	15/32 12	5/16 33.3	1.2205 31.0	0.5000 12.7	M10	3/8	UC 203 203-11	F 203	0.63
UCF 204 204-12	3/4	20	3 3/8 86	33/64 64	19/32 15	15/32 12	1	25.5	15/32 12	5/16 33.3	1.2205 31.0	0.5000 12.7	M10	3/8	UC 204-12 204	F 204	0.63
UCF 205-14 205-15 205 205-16	7/8 15/16 1 1 1/8	25 95	3 3/4 95	2 3/4 70	5/8 16	9/16 14	1 1/16 27	15/32 12	13/32 35.7	1.3386 34	0.5630 14.3	M10	3/8	UC 205-14 205-15 205 205-16	F 205	0.82	
UCF 206-18 206 206-19 206-20	1 1/8 1 3/16 1 1/4	30 108	4 1/4 108	17/64 83	45/64 18	9/16 14	7/32 31	15/32 12	19/32 40.2	1.5000 38.1	0.6260 15.9	M10	3/8	UC 206-18 206 206-19 206-20	F 206	1.10	
UCF 207-20 207-21 207-22 207 207-23	1 1/4 1 5/16 1 3/8 1 7/16	35 117	4 1/2 117	3 5/8 92	3/4 19	5/8 16	1 1/32 34	35/64 14	1 3/4 44.4	1.6890 42.9	0.6890 17.5	M12	7/16	UC 207-20 207-21 207-22 207 207-23	F 207	1.5	
UCF 208-24 208-25 208	1 1/2 1 9/16	40	5 1/8 130	4 1/64 102	53/64 21	5/8 16	1 3/32 36	5/8 16	2 1/64 51.2	1.9370 49.2	0.7480 19.0	M14	1/2	UC 208-24 208-25 208	F 208	1.9	
UCF 209-26 209-27 209-28 209	1 5/8 1 11/16 1 3/4	45	5 3/32 137	4 9/64 105	55/64 22	23/32 18	1 1/2 38	5/8 16	2 1/16 52.2	1.9370 49.2	0.7480 19.0	M14	1/2	UC 209-26 209-27 209-28 209	F 209	2.3	
UCF 210-30 210-31 210 210-32	1 7/8 1 15/16 2	50	5 5/8 143	4 3/8 111	55/64 22	23/32 18	9/16 40	5/8 16	2 5/32 54.6	2.0315 51.6	0.7480 19.0	M14	1/2	UC 210-30 210-31 210 210-32	F 210	2.5	
UCF 211-32 211-34 211 211-35	2 2 1/8 2 3/16	55	6 3/8 162	5 1/8 130	63/64 25	25/32 20	1 1/16 43	3/4 19	2 9/64 58.4	2.1890 55.6	0.8740 22.2	M16	5/8	UC 211-32 211-34 211 211-35	F 211	3.4	
UCF 212-36 212 212-38 212-39	2 1/4 2 3/8 2 7/16	60	6 7/8 175	5 5/8 143	1 9/64 29	25/32 20	7/8 48	3/4 19	45/64 68.7	2.5630 65.1	1.0000 25.4	M16	5/8	UC 212-36 212 212-38 212-39	F 212	4.4	
UCF 213-40 213	2 1/2	65	7 3/8 187	5 5/64 149	1 3/16 30	25/32 20	3 1/32 50	3/4 19	2 3/4 69.7	2.5630 65.1	1.0000 25.4	M16	5/8	UC 213-40 213	F 213	5.3	
UCF 214-44 214	2 3/4	70	7 1/2 193	5 7/64 152	1 1/4 31.8	31/32 24.8	5/4 54.8	3/4 19	3 76.2	2.9370 74.6	1.1890 30.2	M16	5/8	UC 214-44 214	F 214	6.0	
UCF 215 215-47 215-48	75 2 15/16 3	200	7 7/8 200	17/64 159	3 1/8 35	55/64 22	1 1/4 57	3/4 19	1 1/8 79.5	3.0630 77.8	1.3110 33.3	M16	5/8	UC 215 215-47 215-48	F 215	6.6	
UCF 216 216-50	80 3 1/8	208	8 3/16 208	6 1/2 165	1 3/8 35	29/32 23	2 1/4 59	29/32 23	2 1/4 84.3	3.2520 82.6	1.3110 33.3	M20	3/4	UC 216 216-50	F 216	7.5	
UCF 217-52 217	85 3 1/4	220	8 21/32 220	6 5/64 175	1 27/64 36	15/16 24	2 3/32 63	29/32 23	3 7/16 87.6	3.3740 85.7	1.3425 34.1	M20	3/4	UC 217-52 217	F 217	9.1	
UCF 218-56 218	90 3 1/2	235	9 1/4 235	7 23/64 187	1 21/32 42	1 1/16 27	2 1/4 70	29/32 23	3 7/8 98.3	3.7795 96.0	1.5630 39.7	M20	3/4	UC 218-56 218	F 218	11.3	