

# Plain Bore Pulleys for 'H' Series Timing Belts

## Pulley Types

The pulley types referred to in tables are as drawings below. The suffix 'F' indicates pulley has flanges.

Pulleys below dividing line in tables are in Cast iron, and of spoked design. Std. Pulleys can be reworked to customers bore and keyway.

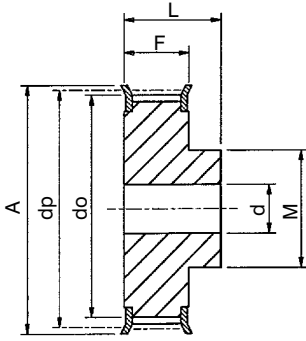

**Type 1F**

Material: Steel

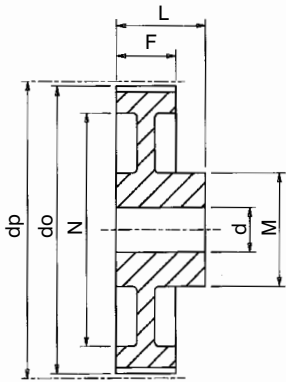

**Type 2**

Material: Cast Iron

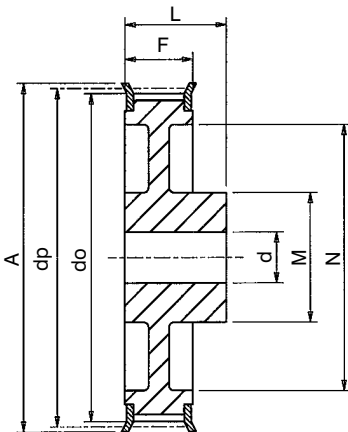

**Type 2F**

Material: Cast Iron

| Catalogue No.  | No. Teeth Z | Pulley Type | Pitch Circle Dia. dp | Min. Bore d | Max. Bore d | Outside Diameter do | Flange Diameter A | Pulley Width F | Bore Length L | Hub Diameter M | Rim Diameter N | Approx Weight kg |
|--|-------------|-------------|----------------------|-------------|-------------|---------------------|-------------------|----------------|---------------|----------------|----------------|------------------|
| <b>1/2" Pitch Pulleys for 1" Wide Belts. Ref. H100</b>     |             |             |                      |             |             |                     |                   |                |               |                |                |                  |
| P14H100  | 14          | 1F          | 56.60                | 11          | 30          | 55.2                | 64                | 32             | 45            | 45             | -              | 0.67             |
| P16H100  | 16          | 1F          | 64.68                | 11          | 30          | 63.3                | 70                | 32             | 45            | 45             | -              | 0.88             |
| P18H100  | 18          | 1F          | 72.77                | 12          | 36          | 71.4                | 79                | 32             | 45            | 55             | -              | 1.06             |
| P19H100  | 19          | 1F          | 76.81                | 14          | 40          | 75.4                | 83                | 32             | 45            | 60             | -              | 1.23             |
| P20H100  | 20          | 1F          | 80.85                | 14          | 41          | 79.5                | 87                | 32             | 45            | 62             | -              | 1.33             |
| P21H100  | 21          | 1F          | 84.89                | 14          | 43          | 83.5                | 91                | 32             | 45            | 65             | -              | 1.43             |
| P22H100  | 22          | 1F          | 88.94                | 14          | 45          | 87.6                | 93                | 32             | 45            | 68             | -              | 1.63             |
| P24H100  | 24          | 1F          | 97.02                | 14          | 47          | 95.7                | 102               | 32             | 45            | 72             | -              | 1.95             |
| P26H100  | 26          | 1F          | 105.11               | 14          | 54          | 103.7               | 112               | 32             | 45            | 80             | -              | 2.30             |
| P28H100  | 28          | 1F          | 113.19               | 14          | 54          | 111.8               | 120               | 32             | 45            | 80             | -              | 2.53             |
| P30H100  | 30          | 1F          | 121.28               | 14          | 54          | 119.9               | 128               | 32             | 45            | 80             | -              | 2.93             |
| P32H100  | 32          | 1F          | 129.36               | 14          | 54          | 128.0               | 135               | 32             | 45            | 80             | -              | 3.06             |
| P36H100  | 36          | 2F          | 145.53               | 14          | 48          | 144.2               | 150               | 32             | 45            | 80             | 118            | 3.92             |
| P40H100  | 40          | 2F          | 161.70               | 14          | 48          | 160.3               | 168               | 32             | 45            | 80             | 134            | 4.95             |
| P44H100  | 44          | 2F          | 177.87               | 14          | 48          | 176.5               | 184               | 32             | 50            | 80             | 150            | 6.20             |
| P48H100  | 48          | 2F          | 194.04               | 14          | 54          | 192.7               | 200               | 32             | 50            | 90             | 166            | 5.30             |
| P60H100  | 60          | 2           | 242.55               | 19          | 54          | 241.2               | -                 | 32             | 50            | 90             | 215            | 7.50             |
| P72H100  | 72          | 2           | 291.06               | 19          | 62          | 289.7               | -                 | 32             | 55            | 100            | 263            | 9.00             |
| P84H100  | 84          | 2           | 339.57               | 19          | 62          | 338.2               | -                 | 32             | 55            | 100            | 312            | 10.00            |
| P96H100  | 96          | 2           | 388.08               | 19          | 70          | 386.7               | -                 | 32             | 60            | 120            | 360            | 13.80            |
| P120H100   | 120         | 2           | 485.10               | 19          | 70          | 483.7               | -                 | 32             | 60            | 120            | 458            | 22.00            |
| <b>1/2" Pitch Pulleys for 1 1/2" Wide Belts. Ref. H150</b> |             |             |                      |             |             |                     |                   |                |               |                |                |                  |
| P14H150  | 14          | 1F          | 56.60                | 11          | 28          | 55.2                | 64                | 46             | 58            | 42             | -              | 0.95             |
| P16H150  | 16          | 1F          | 64.68                | 11          | 30          | 63.3                | 70                | 46             | 58            | 45             | -              | 1.08             |
| P18H150  | 18          | 1F          | 72.77                | 14          | 36          | 71.4                | 79                | 46             | 58            | 55             | -              | 1.45             |
| P19H150  | 19          | 1F          | 76.81                | 14          | 40          | 75.4                | 83                | 46             | 58            | 60             | -              | 1.55             |
| P20H150  | 20          | 1F          | 80.85                | 14          | 41          | 79.5                | 87                | 46             | 58            | 62             | -              | 1.70             |
| P21H150  | 21          | 1F          | 84.89                | 14          | 43          | 83.5                | 91                | 46             | 58            | 65             | -              | 1.87             |
| P22H150  | 22          | 1F          | 88.94                | 14          | 45          | 87.6                | 93                | 46             | 58            | 68             | -              | 2.07             |
| P24H150  | 24          | 1F          | 97.02                | 14          | 47          | 95.7                | 102               | 46             | 58            | 72             | -              | 2.50             |
| P26H150  | 26          | 1F          | 105.11               | 14          | 54          | 103.7               | 112               | 46             | 58            | 80             | -              | 2.99             |
| P28H150  | 28          | 1F          | 113.19               | 14          | 54          | 111.8               | 120               | 46             | 58            | 80             | -              | 3.39             |
| P30H150  | 30          | 1F          | 121.28               | 14          | 54          | 119.9               | 128               | 46             | 58            | 80             | -              | 3.86             |
| P32H150  | 32          | 1F          | 129.36               | 14          | 54          | 128.0               | 135               | 46             | 58            | 80             | -              | 4.37             |
| P36H150  | 36          | 2F          | 145.53               | 14          | 48          | 144.2               | 150               | 46             | 58            | 80             | 118            | 5.50             |
| P40H150  | 40          | 2F          | 161.70               | 14          | 48          | 160.3               | 168               | 46             | 58            | 80             | 134            | 6.80             |
| P44H150  | 44          | 2F          | 177.87               | 19          | 48          | 176.5               | 184               | 46             | 65            | 80             | 150            | 8.50             |
| P48H150  | 48          | 2F          | 194.04               | 19          | 54          | 192.7               | 200               | 46             | 65            | 90             | 166            | 8.80             |
| P60H150  | 60          | 2           | 242.55               | 19          | 54          | 241.2               | -                 | 46             | 65            | 90             | 215            | 9.00             |
| P72H150  | 72          | 2           | 291.06               | 24          | 62          | 289.7               | -                 | 46             | 65            | 100            | 263            | 11.00            |
| P84H150  | 84          | 2           | 339.57               | 24          | 62          | 338.2               | -                 | 46             | 65            | 100            | 312            | 13.00            |
| P96H150  | 96          | 2           | 388.08               | 24          | 70          | 386.7               | -                 | 46             | 65            | 120            | 360            | 17.00            |
| P120H150   | 120         | 2           | 485.10               | 24          | 70          | 483.7               | -                 | 46             | 65            | 120            | 458            | 25.00            |
| <b>1/2" Pitch Pulleys for 2" Wide Belts. Ref. H200</b>     |             |             |                      |             |             |                     |                   |                |               |                |                |                  |
| P14H200  | 14          | 1F          | 56.60                | 11          | 28          | 55.2                | 64                | 59             | 70            | 42             | -              | 1.10             |
| P16H200  | 16          | 1F          | 64.68                | 11          | 30          | 63.3                | 70                | 59             | 70            | 45             | -              | 1.34             |
| P18H200  | 18          | 1F          | 72.77                | 14          | 36          | 71.4                | 79                | 59             | 70            | 55             | -              | 1.65             |
| P19H200  | 19          | 1F          | 76.81                | 14          | 40          | 75.4                | 83                | 59             | 70            | 60             | -              | 1.90             |
| P20H200  | 20          | 1F          | 80.85                | 14          | 41          | 79.5                | 87                | 59             | 70            | 62             | -              | 2.11             |
| P21H200  | 21          | 1F          | 84.89                | 14          | 43          | 83.5                | 91                | 59             | 70            | 65             | -              | 2.23             |
| P22H200  | 22          | 1F          | 88.94                | 14          | 45          | 87.6                | 93                | 59             | 70            | 68             | -              | 2.45             |
| P24H200  | 24          | 1F          | 97.02                | 14          | 47          | 95.7                | 102               | 59             | 70            | 72             | -              | 2.97             |
| P26H200  | 26          | 1F          | 105.11               | 14          | 54          | 103.7               | 112               | 59             | 70            | 80             | -              | 3.61             |
| P28H200  | 28          | 1F          | 113.19               | 14          | 54          | 111.8               | 120               | 59             | 70            | 80             | -              | 4.10             |
| P30H200  | 30          | 1F          | 121.28               | 14          | 54          | 119.9               | 128               | 59             | 70            | 80             | -              | 4.74             |
| P32H200  | 32          | 1F          | 129.36               | 14          | 54          | 128.0               | 135               | 59             | 70            | 80             | -              | 5.60             |
| P36H200  | 36          | 2F          | 145.53               | 14          | 48          | 144.2               | 150               | 59             | 70            | 80             | 118            | 7.10             |
| P40H200  | 40          | 2F          | 161.70               | 14          | 48          | 160.3               | 168               | 59             | 70            | 80             | 134            | 8.40             |
| P44H200  | 44          | 2F          | 177.87               | 19          | 48          | 176.5               | 184               | 59             | 70            | 80             | 150            | 10.50            |
| P48H200  | 48          | 2F          | 194.04               | 24          | 54          | 192.7               | 200               | 59             | 75            | 90             | 166            | 8.60             |
| P60H200  | 60          | 2           | 242.55               | 24          | 54          | 241.2               | -                 | 59             | 75            | 90             | 215            | 11.00            |
| P72H200  | 72          | 2           | 291.06               | 28          | 62          | 289.7               | -                 | 59             | 75            | 100            | 263            | 14.00            |
| P84H200  | 84          | 2           | 339.57               | 28          | 62          | 338.2               | -                 | 59             | 75            | 100            | 312            | 15.00            |
| P96H200  | 96          | 2           | 388.08               | 28          | 70          | 386.7               | -                 | 59             | 75            | 120            | 360            | 20.30            |
| P120H200   | 120         | 2           | 485.10               | 28          | 70          | 483.7               | -                 | 59             | 75            | 120            | 458            | 28.00            |
| <b>1/2" Pitch Pulleys for 3" Wide Belts. Ref. H300</b>     |             |             |                      |             |             |                     |                   |                |               |                |                |                  |
| P14H300  | 14          | 1F          | 56.60                | 11          | 28          | 55.2                | 64                | 86             | 100           | 42             | -              | 1.40             |
| P16H300  | 16          | 1F          | 64.68                | 11          | 30          | 63.3                | 70                | 86             | 100           | 45             | -              | 1.89             |
| P18H300  | 18          | 1F          | 72.77                | 19          | 36          | 71.4                | 79                | 86             | 100           | 55             | -              | 2.38             |
| P19H300  | 19          | 1F          | 76.81                | 19          | 40          | 75.4                | 83                | 86             | 100           | 60             | -              | 2.60             |
| P20H300  | 20          | 1F          | 80.85                | 19          | 41          | 79.5                | 87                | 86             | 100           | 62             | -              | 3.10             |
| P21H300  | 21          | 1F          | 84.89                | 19          | 43          | 83.5                | 91                | 86             | 100           | 65             | -              | 3.32             |
| P22H300  | 22          | 1F          | 88.94                | 19          | 45          | 87.6                | 93                | 86             | 100           | 68             | -              | 3.67             |
| P24H300  | 24          | 1F          | 97.02                | 19          | 47          | 95.7                | 102               | 86             | 100           | 72             | -              | 4.40             |
| P26H300  | 26          | 1F          | 105.11               | 19          | 54          | 103.7               | 112               | 86             | 100           | 80             | -              | 5.20             |
| P28H300  | 28          | 1F          | 113.19               | 19          | 54          | 111.8               | 120               | 86             | 100           | 80             | -              | 5.60             |
| P30H300  | 30          | 1F          | 121.28               | 19          | 54          | 119.9               | 128               | 86             | 100           | 80             | -              | 7.00             |
| P32H300  | 32          | 1F          | 129.36               | 19          | 54          | 128.0               | 135               | 86             | 100           | 80             | -              | 7.80             |
| P36H300  | 36          | 2F          | 145.53               | 19          | 48          | 144.2               | 150               | 86             | 100           | 80             | 118            | 9.90             |
| P40H300  | 40          | 2F          | 161.70               | 19          | 48          | 160.3               | 168               | 86             | 100           | 80             | 134            | 12.20            |
| P44H300  | 44          | 2           | 177.87               | 24          | 48          | 176.5               | -                 | 86             | 100           | 80             | 150            | 15.00            |
| P48H300  | 48          | 2           | 194.04               | 24          | 54          | 192.7               | -                 | 86             | 100           | 90             | 166            | 11.40            |
| P60H300  | 60          | 2           | 242.55               | 24          | 54          | 241.2               | -                 | 86             | 100           | 90             | 215            | 13.30            |
| P72H300  | 72          | 2           | 291.06               | 28          | 62          | 289.7               | -                 | 86             | 100           | 100            | 263            | 19.00            |
| P84H300  | 84          | 2           | 339.57               | 28          | 62          | 338.2               | -                 | 86             | 100           | 100            | 312            | 20.00            |
| P96H300  | 96          | 2           | 388.08               | 28          | 70          | 386.7               | -                 | 86             | 100           | 120            | 360            | 27.00            |
| P120H300   | 120         | 2           | 485.10               | 28          | 70          | 483.7               | -                 | 86             | 100           | 120            | 458            | 33.00            |

Other sizes of Pulleys can be supplied on short delivery. All Pulleys can be supplied finish bored and keywayed.

All dimensions in mm.