

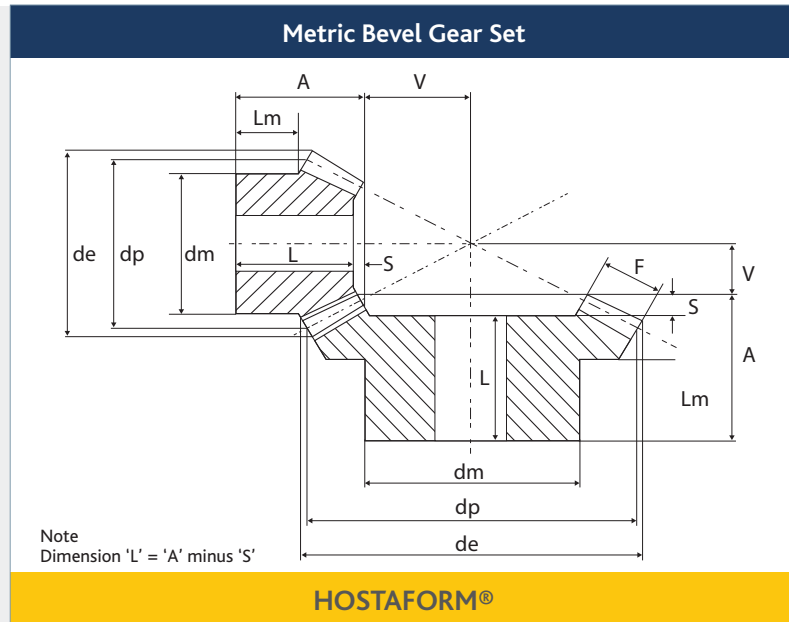

Moulded Bevel Gear Sets, White HOSTAFORM® 2:1 & 3:1 Ratio 1.0 - 3.0 MOD



- Intermediate sizes and special mitres to drawing (tooling charges may apply)
- DIN 3962, 3963, 3967 grade 12
- Standard tolerances, unless otherwise stated ± 0.25 mm.
- Shaft axis to intersect within ± 0.025 mm
- Angular accuracy between shafts ± 5 mins
- Mounting distance tolerance ± 0.05 mm
- Bore tolerance H9
- Max. recommended working temperature 90°C
- 20° pressure angle
- Supplied in pairs
- All dimensions in mm
- White HOSTAFORM® C

2:1 Ratio

Code	Pitch module	No. teeth	dp (mm)	de (mm)	dm (mm)	Bore	F (mm)	Lm (mm)	A (mm)	A+V (mm)	S (mm)
WPRB10/2	1	15	15	16.8	12.2	5	6.6	10.6	17	26.4	0
	1	30	30	31.1	18	8	6.6	9.1	16.2	20.9	1.4
WPRB15/2	1.5	15	22.5	25.4	17	8	11	11.5	22.8	35.8	0
	1.5	30	45	46.4	23.4	10	11	9.6	19.5	26.2	2
WPRB20/2	2	15	30	33.6	22.5	10	15	11.8	27	44.2	1
	2	30	60	62.2	30.2	12	15	11.8	24.2	32.6	1.6
WPRB25/2	2.5	15	37.5	42	26.5	12	17	13	31.2	53.3	1.6
	2.5	30	75	77.3	36.1	16	17	15	29.5	40.5	2
WPRB30/2	3	15	45	50.3	31.2	14	21	14.8	36.3	63.3	1.3
	3	30	90	93	45	18	21	19	37	49.5	2.8

3:1 Ratio

Code	Pitch module	No. teeth	dp	de	dm	Bore	F	Lm	A	A+V	S
WPRB10/3	1	15	15	16.6	12.3	5	9.2	11	20.4	34.3	0
	1	45	45	46.1	23.4	10	9.2	9.6	18.2	22.7	1.7
WPRB15/3	1.5	15	22.5	25.1	17.2	8	14	12.5	26.8	47.9	0
	1.5	45	67.5	68.8	30.4	12	14	11.5	23	29.4	1.5
WPRB20/3	2	10	20	24	16.6	6	13	12	25	43.7	0
	2	30	60	61.7	30.3	12	13	11.5	22.5	28	2.3
WPRB25/3	2.5	10	25	29.7	18.8	8	16	13	28.8	52.4	0
	2.5	30	75	77.2	36.1	18	16	15.5	29	35.7	3.8

Please note: All dimensions subject to change. If a dimension is critical to your application please contact our Sales Department for confirmation. For special or reworked gears please contact our Manufacturing Department for a quotation.

Moulded Bevel Gear Sets, White HOSTAFORM® 4:1 & 5:1 Ratio

1.0 - 2.0 MOD

Drive-flex



Metric Bevel Gear Set

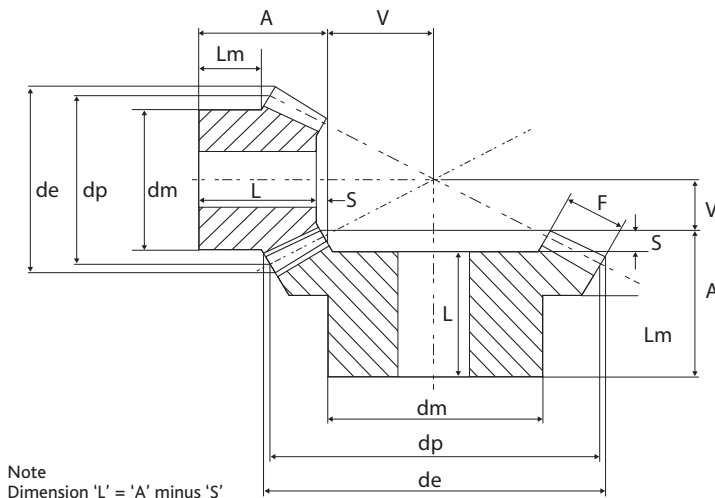

HOSTAFORM®

- Intermediate sizes and special mitres to drawing (tooling charges may apply)
- DIN 3962, 3963, 3967 grade 12
- Standard tolerances, unless otherwise stated ± 0.25 mm
- Shaft axis to intersect within ± 0.025 mm
- Angular accuracy between shafts ± 5 mins
- Mounting distance tolerance ± 0.05 mm
- Bore tolerance H9
- Max. recommended working temperature 90°C
- 20° pressure angle
- Supplied in pairs
- All dimensions in mm
- White HOSTAFORM® C

4:1 Ratio

Code	Pitch module	No. teeth	dp (mm)	de (mm)	dm (mm)	Bore	F (mm)	Lm (mm)	A (mm)	A+V (mm)	S (mm)
WPRB10/4	1	10	10	12	7.8	4	8.2	9.3	17.7	30.1	0
	1	40	40	40.8	23.4	10	8.2	10.8	17	20.1	1.3
WPRB15/4	1.5	10	15	18	11.3	5	12	10.9	23.5	41.7	0
	1.5	40	60	61.2	30.4	12	12	12.8	21.7	26.2	1.7
WPRB20/4	2	10	20	23.8	14.3	6	16	12.8	28.9	54	0
	2	40	80	81.5	36	18	16	16.6	27	32.5	2.3

5:1 Ratio

Code	Pitch module	No. teeth	dp (mm)	de (mm)	dm (mm)	Bore (mm)	F (mm)	Lm (mm)	A (mm)	A+V (mm)	S (mm)
WPRB10/5	1	12	12	13.7	9.5	4	9.5	10	20.3	40.5	0
	1	60	60	60.4	20.5	10	9.5	11	17.4	21	1.9

Please note: All dimensions subject to change. If a dimension is critical to your application please contact our Sales Department for confirmation. For special or reworked gears please contact our Manufacturing Department for a quotation.