

Taper Bore Pulleys for HTD Size 8M Belts

| 8mm Pitch Pulleys for 20mm Wide Belt Ref. 8M20 | | | | | | | | | | | | |
|--|-----|-----|--------|------|----|-------|-----|----|----|-----|-----|-------|
| 22-8M-20 | 22 | 5F | 56.02 | 1108 | 28 | 54.7 | 60 | 28 | 22 | - | 37 | 0.26 |
| 24-8M-20 | 24 | 5F | 61.12 | 1108 | 28 | 59.8 | 66 | 28 | 22 | - | 44 | 0.30 |
| 26-8M-20 | 26 | 5F | 66.21 | 1108 | 28 | 64.9 | 70 | 28 | 22 | - | 45 | 0.36 |
| 28-8M-20 | 28 | 5F | 71.30 | 1108 | 28 | 70.1 | 75 | 28 | 22 | - | 50 | 0.44 |
| 30-8M-20 | 30 | 5F | 76.39 | 1108 | 28 | 75.1 | 83 | 28 | 22 | - | 58 | 0.53 |
| 32-8M-20 | 32 | 5F | 81.49 | 1610 | 42 | 80.2 | 87 | 28 | 25 | - | 63 | 0.42 |
| 34-8M-20 | 34 | 5F | 86.58 | 1610 | 42 | 85.2 | 91 | 28 | 25 | - | 64 | 0.55 |
| 36-8M-20 | 36 | 5F | 91.67 | 1610 | 42 | 90.3 | 97 | 28 | 25 | - | 68 | 0.68 |
| 38-8M-20 | 38 | 5F | 96.77 | 1610 | 42 | 95.4 | 102 | 28 | 25 | - | 72 | 0.80 |
| 40-8M-20 | 40 | 5F | 101.86 | 1610 | 42 | 100.5 | 106 | 28 | 25 | - | 76 | 1.00 |
| 44-8M-20 | 44 | 8F | 112.05 | 2012 | 50 | 110.7 | 120 | 28 | 32 | 93 | - | 1.20 |
| 48-8M-20 | 48 | 8F | 122.23 | 2012 | 50 | 120.9 | 128 | 28 | 32 | 96 | - | 1.60 |
| 56-8M-20 | 56 | 8F | 142.60 | 2012 | 50 | 141.2 | 150 | 28 | 32 | 110 | - | 2.40 |
| 64-8M-20 | 64 | 11F | 162.97 | 2012 | 50 | 161.6 | 168 | 28 | 32 | 110 | 137 | 2.70 |
| 72-8M-20 | 72 | 11F | 183.35 | 2012 | 50 | 182.0 | 192 | 28 | 32 | 110 | 158 | 3.30 |
| 80-8M-20 | 80 | 11 | 203.72 | 2012 | 50 | 202.4 | - | 28 | 32 | 110 | 180 | 3.50 |
| 90-8M-20 | 90 | 11 | 229.18 | 2012 | 50 | 227.8 | - | 28 | 32 | 110 | 204 | 3.65 |
| 8mm Pitch Pulleys for 30mm Wide Belt Ref. 8M30 | | | | | | | | | | | | |
| 22-8M-30 | 22 | 5F | 56.02 | 1108 | 28 | 54.7 | 60 | 38 | 22 | - | 37 | 0.32 |
| 24-8M-30 | 24 | 5F | 61.12 | 1108 | 28 | 59.8 | 66 | 38 | 22 | - | 44 | 0.38 |
| 26-8M-30 | 26 | 5F | 66.21 | 1108 | 28 | 64.9 | 70 | 38 | 22 | - | 44 | 0.45 |
| 28-8M-30 | 28 | 5F | 71.30 | 1210 | 32 | 70.1 | 75 | 38 | 25 | - | 50 | 0.50 |
| 30-8M-30 | 30 | 9F | 76.39 | 1615 | 42 | 75.1 | 83 | 38 | 38 | - | - | 0.55 |
| 32-8M-30 | 32 | 9F | 81.49 | 1615 | 42 | 80.2 | 87 | 38 | 38 | - | - | 0.59 |
| 34-8M-30 | 34 | 9F | 86.58 | 1615 | 42 | 85.2 | 91 | 38 | 38 | - | - | 0.77 |
| 36-8M-30 | 36 | 9F | 91.67 | 1615 | 42 | 90.3 | 97 | 38 | 38 | - | - | 0.96 |
| 38-8M-30 | 38 | 9F | 96.77 | 1615 | 42 | 95.4 | 102 | 38 | 38 | - | - | 1.15 |
| 40-8M-30 | 40 | 9F | 101.86 | 1615 | 42 | 100.5 | 106 | 38 | 38 | - | - | 1.34 |
| 44-8M-30 | 44 | 13F | 112.05 | 2012 | 50 | 110.7 | 120 | 38 | 32 | - | 86 | 1.33 |
| 48-8M-30 | 48 | 13F | 122.23 | 2012 | 50 | 120.9 | 128 | 38 | 32 | - | 90 | 1.78 |
| 56-8M-30 | 56 | 13F | 142.60 | 2012 | 50 | 141.2 | 150 | 38 | 32 | - | 110 | 3.76 |
| 64-8M-30 | 64 | 8F | 162.97 | 2517 | 60 | 161.6 | 168 | 38 | 45 | 125 | - | 4.20 |
| 72-8M-30 | 72 | 11F | 183.35 | 2517 | 60 | 182.0 | 192 | 38 | 45 | 125 | 158 | 4.30 |
| 80-8M-30 | 80 | 11 | 203.72 | 2517 | 60 | 202.4 | - | 38 | 45 | 125 | 180 | 4.60 |
| 90-8M-30 | 90 | 11 | 229.18 | 2517 | 60 | 227.8 | - | 38 | 45 | 125 | 204 | 5.00 |
| 112-8M-30 | 112 | 11 | 285.21 | 2517 | 60 | 283.8 | - | 38 | 45 | 125 | 254 | 6.20 |
| 144-8M-30 | 144 | 11 | 366.69 | 2517 | 60 | 365.3 | - | 38 | 45 | 125 | 336 | 9.00 |
| 8mm Pitch Pulleys for 50mm Wide Belt Ref. 8M50 | | | | | | | | | | | | |
| 28-8M-50 | 28 | 13F | 71.30 | 1210 | 32 | 70.1 | 75 | 60 | 25 | - | 50 | 0.60 |
| 30-8M-50 | 30 | 5F | 76.39 | 1615 | 42 | 75.1 | 83 | 60 | 38 | - | 58 | 0.65 |
| 32-8M-50 | 32 | 5F | 81.49 | 1615 | 42 | 80.2 | 87 | 60 | 38 | - | 62 | 0.82 |
| 34-8M-50 | 34 | 5F | 86.58 | 1615 | 42 | 85.2 | 91 | 60 | 38 | - | 65 | 1.06 |
| 36-8M-50 | 36 | 5F | 91.67 | 1615 | 42 | 90.3 | 97 | 60 | 38 | - | 68 | 1.30 |
| 38-8M-50 | 38 | 5F | 96.77 | 1615 | 42 | 95.4 | 102 | 60 | 38 | - | 72 | 1.60 |
| 40-8M-50 | 40 | 13F | 101.86 | 2012 | 50 | 100.5 | 106 | 60 | 32 | - | 82 | 1.71 |
| 44-8M-50 | 44 | 13F | 112.05 | 2012 | 50 | 110.7 | 120 | 60 | 32 | - | 91 | 1.78 |
| 48-8M-50 | 48 | 13F | 122.23 | 2012 | 50 | 120.9 | 128 | 60 | 32 | - | 95 | 2.30 |
| 56-8M-50 | 56 | 13F | 142.60 | 2517 | 60 | 141.2 | 150 | 60 | 45 | - | 116 | 3.40 |
| 64-8M-50 | 64 | 13F | 162.97 | 2517 | 60 | 161.6 | 168 | 60 | 45 | - | 137 | 5.00 |
| 72-8M-50 | 72 | 12F | 183.35 | 2517 | 60 | 182.0 | 192 | 60 | 45 | 125 | 158 | 6.70 |
| 80-8M-50 | 80 | 13 | 203.72 | 3020 | 75 | 202.4 | - | 60 | 51 | - | 180 | 8.80 |
| 90-8M-50 | 90 | 12 | 229.18 | 3020 | 75 | 227.8 | - | 60 | 51 | 170 | 204 | 10.00 |
| 112-8M-50 | 112 | 12 | 285.21 | 3020 | 75 | 283.8 | - | 60 | 51 | 170 | 260 | 12.00 |
| 144-8M-50 | 144 | 12 | 366.69 | 3020 | 75 | 365.3 | - | 60 | 51 | 170 | 341 | 15.20 |
| 168-8M-50 | 168 | 7 | 427.81 | 3525 | 90 | 426.4 | - | 60 | 65 | 198 | 402 | 17.50 |
| 192-8M-50 | 192 | 7 | 488.92 | 3525 | 90 | 487.6 | - | 60 | 65 | 198 | 460 | 24.00 |
| 8mm Pitch Pulleys for 85mm Wide Belt Ref. 8M85 | | | | | | | | | | | | |
| 34-8M-85 | 34 | 13F | 86.58 | 1615 | 42 | 85.2 | 91 | 95 | 38 | - | 65 | 1.43 |
| 36-8M-85 | 36 | 13F | 91.67 | 1615 | 42 | 90.3 | 97 | 95 | 38 | - | 68 | 1.87 |
| 38-8M-85 | 38 | 13F | 96.77 | 1615 | 42 | 95.4 | 102 | 95 | 38 | - | 72 | 2.20 |
| 40-8M-85 | 40 | 13F | 101.86 | 2012 | 50 | 100.5 | 106 | 95 | 32 | - | 82 | 1.80 |
| 44-8M-85 | 44 | 13F | 112.05 | 2012 | 50 | 110.7 | 120 | 95 | 32 | - | 91 | 2.30 |
| 48-8M-85 | 48 | 13F | 122.23 | 2517 | 60 | 120.9 | 128 | 95 | 45 | - | 100 | 2.66 |
| 56-8M-85 | 56 | 13F | 142.60 | 2517 | 60 | 141.2 | 150 | 95 | 45 | - | 117 | 4.45 |
| 64-8M-85 | 64 | 13F | 162.97 | 2517 | 60 | 161.6 | 168 | 95 | 45 | - | 137 | 6.20 |
| 72-8M-85 | 72 | 13F | 183.35 | 3020 | 75 | 182.0 | 192 | 95 | 51 | - | 158 | 8.00 |
| 80-8M-85 | 80 | 13 | 203.72 | 3020 | 75 | 202.4 | - | 95 | 51 | - | 180 | 10.00 |
| 90-8M-85 | 90 | 12 | 229.18 | 3020 | 75 | 227.8 | - | 95 | 51 | 170 | 204 | 10.80 |
| 112-8M-85 | 112 | 12 | 285.21 | 3020 | 75 | 283.8 | - | 95 | 51 | 170 | 260 | 15.00 |
| 144-8M-85 | 144 | 12 | 366.69 | 3525 | 90 | 365.3 | - | 95 | 65 | 198 | 336 | 20.00 |
| 168-8M-85 | 168 | 12 | 427.81 | 3525 | 90 | 426.4 | - | 95 | 65 | 198 | 395 | 22.00 |
| 192-8M-85 | 192 | 12 | 488.92 | 3525 | 90 | 487.6 | - | 95 | 65 | 198 | 455 | 26.00 |

Pulley Types

The pulley types referred to in tables are as drawings following. Suffix 'F' indicates pulley has flanges. Pulleys below dividing lines in tables are manufactured in Cast Iron, and pulleys over 300mm diameter generally have lightening holes in web.

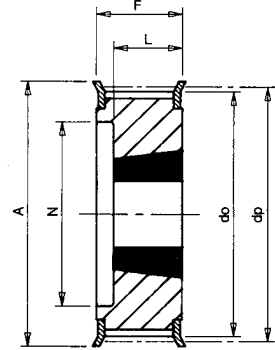

Type 5F

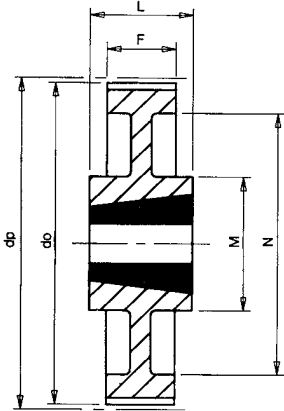

Type 7

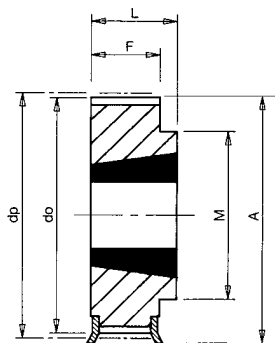

Type 8/8F

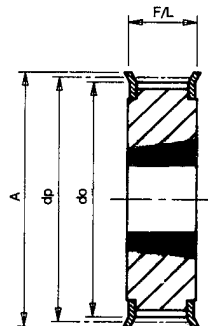

Type 9F

For bore sizes of Taper Bushes for above pulleys refer to page 25. Pulleys are also available with pilot bore ref. pages 17-20. All dimensions in mm.