

**Metric Moulded Bevel Gear Sets, 30% Glass Filled Nylon 6, 1.5:1, 2:1, 3:1 & 4.1 Ratio 1.5 – 3.0 MOD**

**Metric  
Bevel  
Gear Set**

**30%  
GLASS  
FILLED  
NYLON 6**

Intermediate sizes and special bevels to drawing (tooling charges may apply)  
 Standard tolerances, unless otherwise stated  $\pm 0.25$  mm  
 Shaft axis to intersect within  $\pm 0.025$  mm  
 Angular accuracy between shafts  $\pm 5$  mins  
 Mounting distance tolerance  $\pm 0.05$  mm  
 Bore unmachined typically 0.5 – 1 mm undersize  
 Max. recommended working temperature 130°C  
 20° pressure angle  
 Supplied in pairs  
 All dimensions in mm  
 30% Glass filled Nylon 6

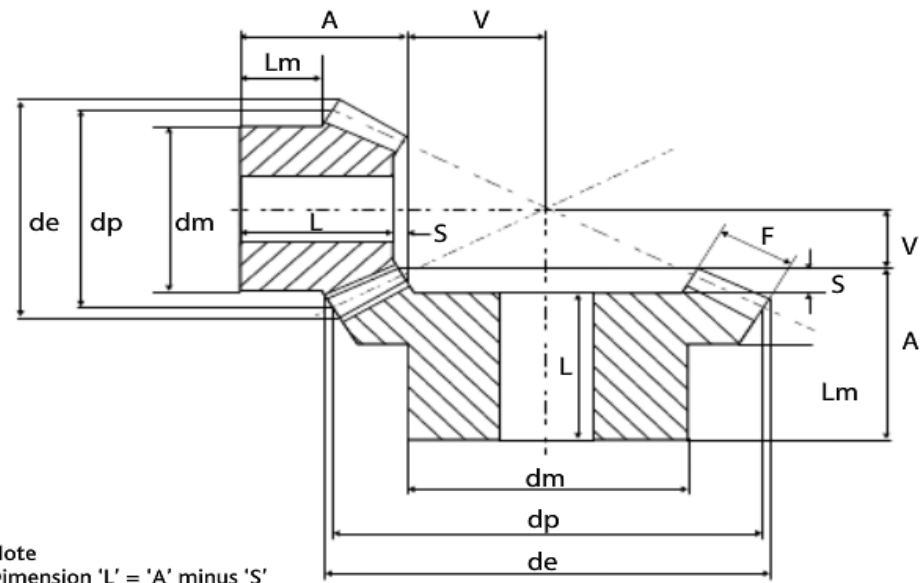

Ratio 1.5 : 1											
Code	Pitch module	No. teeth	dp (mm)	de(mm)	dm (mm)	PreBore (rough)	F(mm)	Lm(mm)	A(mm)	A+V (mm)	S (mm)
PRB20/1. 5	2	20	40	43.3	30	8	10	10.2	23	43.3	0
	2	30	60	62.2	50	11.5	10	15.2	27	40.6	0

Ratio 2 : 1											
Code	Pitch module	No. teeth	dp (mm)	de(mm)	dm (mm)	PreBore (rough)	F(mm)	Lm(mm)	A(mm)	A+V (mm)	S (mm)
PRB15/2	1.5	16	24	26.7	18	8	8	10.3	20	36.4	0
	1.5	32	48	49.3	33	12	8	11.5	20	27.5	0
PRB20/2	2	16	32	35.6	24	10	10	12.2	23	45.4	0
	2	32	64	65.8	40	12	10	10	25	35.2	0
PRB25/2	2.5	16	40	44.4	30	12	12	14.4	27.5	56	2.5
	2.5	32	80	82.2	50	15	13	10	30	43.5	3.5
PRB30/2	3	16	48	53.4	40.5	14	15	11.6	28	61.6	0
	3	32	96	98.7	60	16	15	15	34	50.4	0

Ratio 3 : 1											
Code	Pitch module	No. teeth	dp (mm)	de (mm)	dm (mm)	PreBore (rough)	F	Lm	A	A+V	S
PRB15/3	1.5	16	24	26.9	20	8	12	9.7	22	46.3	0
	1.5	48	72	72.9	42	15	12	12	21	29.2	0
PRB20/3	2	16	32	35.8	25	10	15	9.4	25.5	58.9	1.5
	2	48	96	97.3	50	15	15	13	26	35.9	4
PRB25/3	2.5	16	40	44.7	34	14	18	9.2	26	70.4	0
	2.5	48	120	121.6	60	20	18	16	32	44.6	7
PRB30/3	3	16	48	53.7	35	10	18	11.2	30	84.2	0
	3	48	144	145.9	50	20	18	19	38	54.1	6

Ratio 4 : 1											
Code	Pitch module	No. teeth	dp (mm)	de (mm)	dm (mm)	PreBore (rough)	F	Lm	A	A+V	S
PRB20/4	2	16	32	35.9	25	12	15	8.5	24	73.1	1
	2	64	128	129	70	20	15	14	28	38.9	1
PRB25/4	2.5	16	40	44.9	32	15	18	11.7	30.5	92.6	0
	2.5	64	160	161.2	80	20	18	16	35	48.8	5
PRB30/4	3	16	48	53.8	35	10	20	11.1	32	108	0
	3	64	192	193.5	60	19	20	22	42	58.8	6