

Metric Spiral Bevel Gear in Steel 2:1 Ratio, 1.5 - 5.0 MOD

Drive-flex

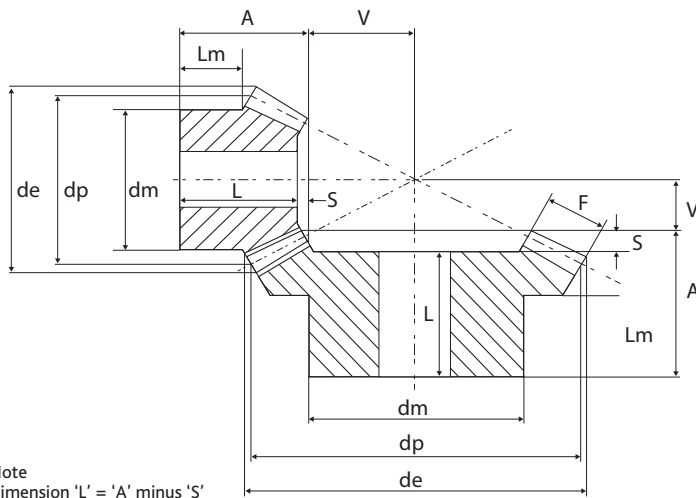

Metric Spiral Bevel Gear Set



Note
Dimension 'L' = 'A' minus 'S'

Steel

- Intermediate sizes and special bevels to drawing
- Standard tolerances, unless otherwise stated ± 0.25 mm
- Shaft axis to intersect within ± 0.025 mm
- Angular accuracy between shafts ± 5 mins
- Mounting distance tolerance ± 0.05 mm
- Pitch angle 45°
- Pinion left hand, gear wheel right hand
- Bore tolerance H8
- Cut to the Gleason System
- 20° pressure angle
- Supplied in pairs
- All dimensions in mm
- Steel EN8, (080M40/080M46) or equivalent

Code	Pitch module	No. teeth	dp (mm)	de (mm)	dm (mm)	Bore (H8)	F (mm)	Lm (mm)	A (mm)	V+A (mm)	S (mm)
SRBSP15/2	1.5	16	24	27	20	10	8	9.5	18.6	35	1.6
	1.5	32	48	48	32	12	8	10	20	28	2
SRBSP20/2	2	16	32	36	27	10	10	11.7	22.5	45	1.5
	2	32	64	65	40	12	10	10	24.1	35	2.6
SRBSP25/2	2.5	16	40	45	32	12	12	14	27.5	56	2.4
	2.5	32	80	81	50	15	12	15	29.2	43	3.3
SRBSP30/2	3	16	48	54	40	15	15	12	28.4	62	3.2
	3	32	96	97	60	15	15	15	34.6	51	4.8
SRBSP40/2	4	16	64	72	50	20	20	13.5	36.2	81	4
	4	32	128	129	80	20	20	23	44.2	66	5.5
SRBSP50/2	5	16	80	90	60	20	25	21	50	106	4.7
	5	32	160	162	90	25	25	27	53.7	81	6.9

Please note: All dimensions subject to change. If a dimension is critical to your application please contact our Sales Department for confirmation. For special or reworked gears please contact our Manufacturing Department for a quotation.