

Spiral Mitre Gear Sets in Steel, 1.5 - 5.0 MOD

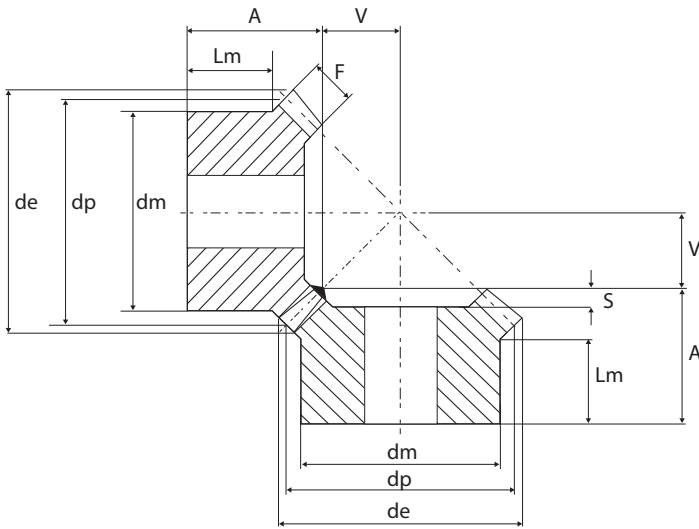

Metric Mitre Gear Set



Steel

- Intermediate sizes and special mitres to drawing
- Standard tolerances, unless otherwise stated ± 0.25 mm
- Shaft axis to intersect within ± 0.025 mm
- Angular accuracy between shafts ± 5 mins
- Mounting distance tolerance ± 0.05 mm
- Bore tolerance H8
- Cut to the Gleason System
- 20° pressure angle
- Pitch angle 45°
- Supplied in pairs
- All dimensions in mm
- Steel EN8, (080M40/080M46) or equivalent

Code	Pitch module	No. teeth	dp (mm)	de (mm)	dm (mm)	Bore (H8)	F (mm)	Lm (mm)	A (mm)	A+V (mm)	S (mm)
SBMSP15/16	1.5	16	24	25	18	8	6	9	16.7	24	0.7
SBMSP15/20	1.5	20	30	31	22	8	7	10	19.4	29	1.4
SBMSP15/25	1.5	25	38	39	28	8	8	11.5	26.5	35	6.5
SBMSP15/30	1.5	30	45	46	32	10	10	11	31.8	40	10.3
SBMSP20/16	2	16	32	34	25	10	9	9.45	19.9	29	3
SBMSP20/20	2	20	40	42	32	10	12	11.95	24.9	36	3.2
SBMSP20/25	2	25	50	52	40	12	14	11.9	27.4	42	2.6
SBMSP20/30	2	30	60	62	50	12	16	12.95	29.9	48	3
SBMSP25/16	2.5	16	40	43	32	12	10	13	24.8	37	3
SBMSP25/20	2.5	20	50	53	40	12	12	16	30.2	46	3.5
SBMSP25/25	2.5	25	63	65	50	15	15	16	33.2	53	3.3
SBMSP25/30	2.5	30	75	78	55	15	18	16	35	59	3.2
SBMSP30/16	3	16	48	51	40	15	12	16	29.4	44	3.6
SBMSP30/20	3	20	60	63	45	15	18	13.5	34.5	51	3.8
SBMSP30/25	3	25	75	78	55	15	20	16	37.5	60	3.8
SBMSP30/30	3	30	90	93	60	20	22	19	39.5	68	3.7
SBMSP40/16	4	16	64	68	50	15	15	17.75	36	56	5.2
SBMSP40/20	4	20	80	84	60	18	17	18	37.5	64	5
SBMSP40/25	4	25	100	104	70	20	21	18	40.4	74	5.2
SBMSP40/30	4	30	120	124	80	25	25	16	43.2	84	5.1
SBMSP50/16	5	16	80	85	60	20	17	18.9	41	68	5.5
SBMSP50/20	5	20	100	105	70	20	21	18.5	44	78	6.3
SBMSP50/25	5	25	125	130	90	20	26	18.5	47.8	90	6
SBMSP50/30	5	30	150	155	110	30	32	18	52.5	103	6.8

Please note: All dimensions subject to change. If a dimension is critical to your application please contact our Sales Department for confirmation. For special or reworked gears please contact our Manufacturing Department for a quotation.